

CERTIFIED LAND CORNER RESTORATION

Index No. B-5

State of Wisconsin }
 County of Langlade } ss.

I Daniel K. Pleoger, do hereby
 certify that on the 15th day
 of December, 1980, I ~~found~~
~~restored~~ the N 1/16
 corner of Sections 5 & 6
 Township 33, North, Range
9 East, Fourth Principal Meridian,
 as described hereon; and that from this evidence
 I established a new monument and accessories
 as described hereon to perpetuate the original
 location of this corner.

Resident witnesses:

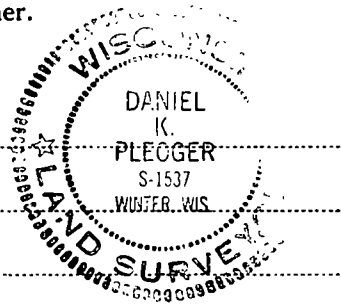

FORM 985 H.C. Miller Company, Inc. Stock No. 26272

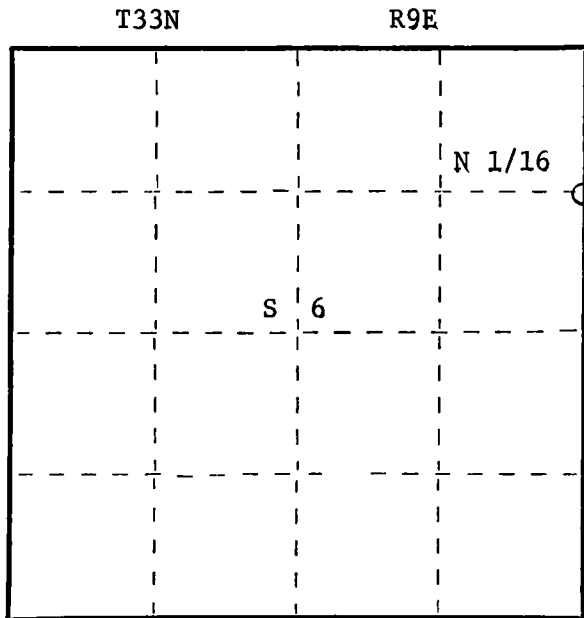

○ = Corner monument restored.

History of original corner establishment:
 1938 Langlade County Surveyors established N 1/16 corner.
 Town of Summit plat shows a total distance from section corner 5-6-31-32, T33 & 34N, R9E to 1/4
 between sections 5 & 6 of 2643.96 ft. N 1/16 as being south 1390.62 ft. of section corner
 and north 1253.34 ft. of 1/4 corner.

Description of corner evidence found:
 Ran traverse from section corner 5-6-31-32, T33 & 34N, R9E to 1/4 corner between
 sections 5 & 6 for a distance of 2637.28 ft.
 Set N 1/16 in proportional distance to original survey.
 N 1/16 sets S 1-14-15W 1326.18 ft. of section corner and N-14-15E 1311.10 ft. of 1/4
 corner.

Description of monument and accessories I established to perpetuate the original location of this corner.
 Set a 1/2" square spike in C.T.H. "H" for true corner. Spike is 3" below road surface.
 Falls 4.0 ft. east of centerline.
 Set a 2" iron pipe with brass cap 60.0 ft. east of true corner, cap stamped:
 Monument projects 18" above ground.
 Marked NBTs to true corner
 Maple 6" N71W 92.43 ft.)
 Maple 6" S74W 79.78 ft.) Scribed 1/16 - B.T.
T33N R9E
 N 1/16 $\frac{6}{5}$ W.C.
 W. 60 ft. to Cor.
 S1537 - 1980

Dated at Rhineland, Wis., this 6th day of May, 1980

Signature Daniel K. Pleoger Title Registered Land Surveyor Registration No. S1537
 (County Surveyor, Registered Land Surveyor, or other duly authorized official)

Office of Register of Deeds, County of _____, I hereby certify that the within
 instrument was filed in this office for record on the _____ day of _____, 19____
 at _____ o'clock _____ M.

 (Register of Deeds)

By _____ Deputy

CERTIFIED LAND CORNER RESTORATION

Index No. B-5

33-9

State of Wisconsin }
County of Laporte } ss.

I, Raymond S. Hallisy, do hereby certify that on the 15th day of May, 1976, I found evidence of the N 1/4 corner of Section 5 & 6 Township 33, North, Range 9 E, Fourth Principal Meridian, as described hereon; and that from this evidence I established a new monument and accessories as described hereon to perpetuate the original location of this corner.

Resident witnesses:

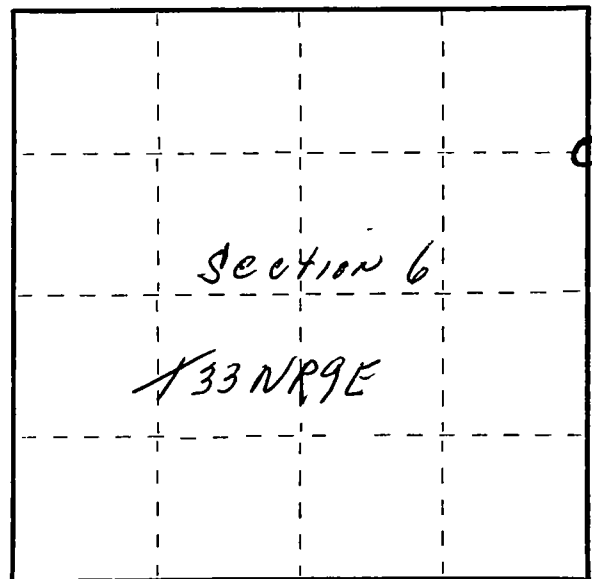

○ = Corner monument restored.

History of original corner establishment:

Corner Set in 1930 Resurvey
Destroyed in Hiway Construction

Description of corner evidence found:

MEASURED FROM SECTION CORNER $\frac{31}{65}$ SOUTH TO $\frac{1}{4}$ C/5
OUR DISTANCE 40.01 CHAINS, RESURVEY DISTANCE 40.06 CHAINS
SET N 1/4 AT 21.045 CHAINS SOUTH OF SECTION CORNER
AND 18.965 CHAINS NORTH OF $\frac{1}{4}$ CORNER,
ORIGINAL SET AT 21.07 CHAINS SOUTH OF SECTION CORNER
AND 18.99 CHAINS ~~SOUTH~~ NORTH OF $\frac{1}{4}$ CORNER

Description of monument and accessories I established to perpetuate the original location of this corner.

SET WITNESS CORNER 50 LINKS EAST OF CORNER

BT'S TO WITNESS CORNER

HEMLOCK 18 S 79 E 86 FT
RED MAPLE CLUMP 6 N 12 E 80.9 FT

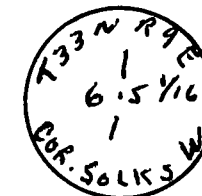

Dated at Antigo, Wis., this 15th day of May, 1976.

Signature Raymond S. Hallisy Title Reg Land Surveyor Registration No. 5-685
(County Surveyor, Registered Land Surveyor, or other duly authorized official)

Office of Register of Deeds, County of Laporte, I hereby certify that the within instrument was filed in this office for record on the 15th day of May, 1976 at 10 o'clock AM.

(Register of Deeds)

By _____ Deputy