

CERTIFIED LAND CORNER RESTORATION

Index No. C-5

State of Wisconsin }
County of Lanlade } ss.

I Daniel K. Pleoger, do hereby certify that on the 18th day of December, 1980, I found evidence of the Quarter corner of Sections 5 and 6 Township 33, North, Range 9 East, Fourth Principal Meridian, as described hereon; and that from this evidence I established a new monument and accessories as described hereon to perpetuate the original location of this corner.

Resident witnesses:

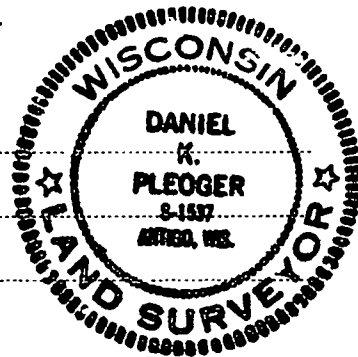

FORM 985 H. C. MILLER CO., MILWAUKEE

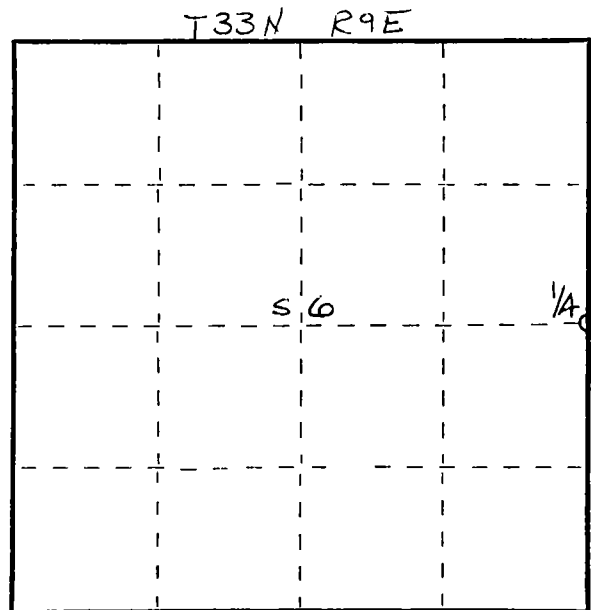

○ = Corner monument restored.

History of original corner establishment:

Original corner established by H.C. Fellows, deputy surveyor, in 1859 from which Birch 12" bears N70°W 10 links and Birch 14" bears S50°E 12 links.

Description of corner evidence found:

Recovered a 4" iron pipe filled with concrete and capped with a 4" diameter brass cap - stamped:
Projecting 30" above ground.

Lanlade County
T33N R9E
1/4 S 6 | 5
4-18-38
Cor. 50 lks. W.

Description of monument and accessories I established to perpetuate the original location of this corner.

Set a 1/2" x 3/4" bolt in C.T.H. "H" for true corner 50 links east of witness corner.
Set a 2-1/2" aluminum pipe 85.00 feet west of true corner, alloy cap stamped:

Marked NBT's:

Sugar 8" N63°W 117.02 feet
Sugar 7" S64°W 99.26 feet
both scribed 1/4 B.T.

T33N R9E
1/4 6 | 5 W.C.
E. 85 ft. to Cor.
S1537 - 1980

Dated at Rhineland, Wis., this 24th day of April, 1981.

Signature Daniel K. Pleoger Title Registered Land Surveyor Registration No. 1537
(County Surveyor, Registered Land Surveyor, or other duly authorized official)

Office of Register of Deeds, County of _____, I hereby certify that the within instrument was filed in this office for record on the _____ day of _____, 19____ at _____ o'clock _____ M.

(Register of Deeds)

By _____ Deputy