

CERTIFIED LAND CORNER RESTORATION

Index No. C-10

State of Wisconsin }
County of Langlade } ss.

History of original corner establishment:
No evidence of any previous corner.

I Glen Barker, do hereby certify that on the 4th day of May, 19 83, I ~~found~~ found evidence of the WC 1/16 corner of Section 4 Township 33, North, Range 9 East, Fourth Principal Meridian, as described hereon; and that from this evidence I established a new monument and accessories as described hereon to perpetuate the original location of this corner.

Description of corner evidence found:

Total distance from C 1/4 Section 4 to 1/4 corner between Sections 4 & 5 is 2660.42 ft.
Set WC 1/16 1330.21 ft. intermediate.

Resident witnesses:

J. Clafflin - R.L.S.
H. Wagoner

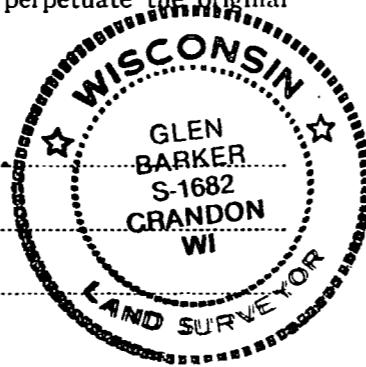

Description of monument and accessories I established to perpetuate the original location of this corner.

Set a 1" iron pipe with 2" diameter alloy cap stamped:

S1682

Monument projects 18" above ground.

T33N R9E

Marked NBTs:

Cedar 10" S77W 12.41 ft.
Cedar 10" S20E 20.08 ft.
Scribed 1/16 - B.T.

WC 1/16 S 4
CPI - 1983

Stock No. 26272
FORM 985
M.C. Miller Company
Surveyors' and
Plumbers' Association

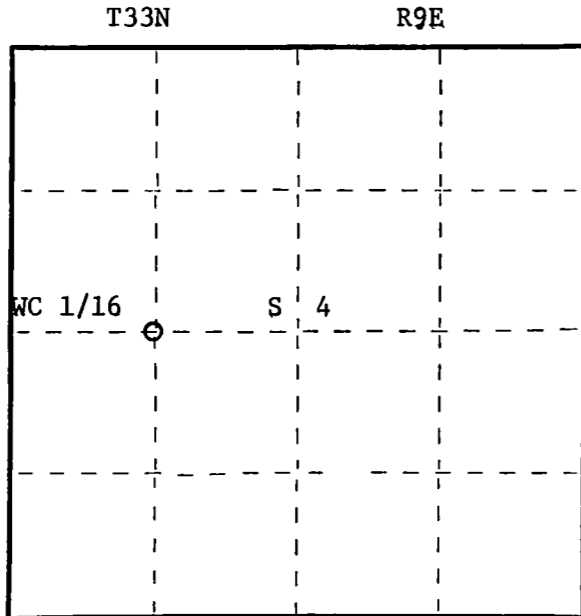

○ = Corner monument restored.

Dated at Rhineland, Wis., this 9th day of June, 1983.

Signature Glen Barker Title Registered Land Surveyor Registration No. S1682
(County Surveyor, Registered Land Surveyor, or other duly authorized official)

Office of Register of Deeds, County of _____, I hereby certify that the within instrument was filed in this office for record on the _____ day of _____, 19____ at _____ o'clock _____ M.

(Register of Deeds)

By _____ Deputy