

CERTIFIED LAND CORNER RESTORATION

Index No. D-11

State of Wisconsin }
County of Langlade } ss.

History of original corner establishment:
No evidence of any previous corner.

I, Glen Barker, do hereby
certify that on the 3rd day
of May, 19 83, I ~~found~~ restored
~~evidence of the~~ SC 1/16
corner of Section 4
Township 23, North, Range
9 East, Fourth Principal Meridian,
as described hereon; and that from this evidence
I established a new monument and accessories
as described hereon to perpetuate the original
location of this corner.

Description of corner evidence found:

Total distance from 1/4 corner between sections 4 & 9 to C 1/4 section 4 is 2680.30 ft.
Set SC 1/16 1340.15 ft. intermediate.

Resident witnesses:

J. Claflin - R.L.S.

H. Wagoner

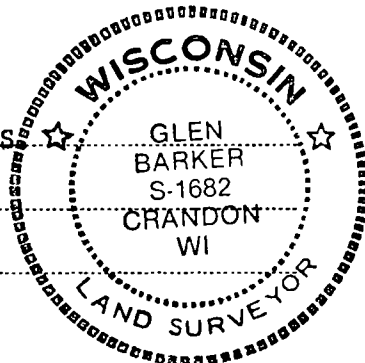

Description of monument and accessories I established to perpetuate the original location of this corner.

Set a 2" iron pipe with brass cap stamped:

T33N R9E

Monument projects 18" above ground.

SC 1/16 S 4

Marked NBTs:

Maple 6" South 44.58 ft.

S1682 - 1983

Black Ash 10" N65W 31.28 ft.

Scribed 1/16 - B.T.

T33N R9E

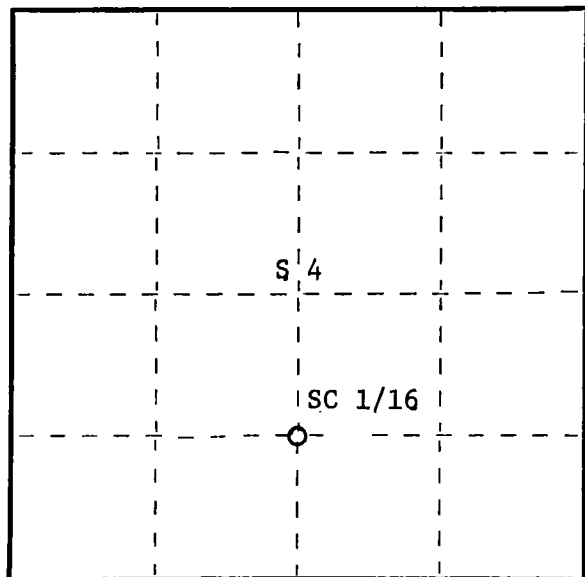

○ = Corner monument restored.

Dated at Rhineland, Wis., this 9th day of June, 19 83.

Signature Glen Barker Title Registered Land Surveyor Registration No. S1682
(County Surveyor, Registered Land Surveyor, or other duly authorized official)

Office of Register of Deeds, County of _____, I hereby certify that the within
instrument was filed in this office for record on the _____ day of _____, 19 _____
at _____ o'clock _____ M.

(Register of Deeds)

By _____ Deputy

Stock No. 26272



FORM 985