

CERTIFIED LAND CORNER RESTORATION

Index No. D-10

State of Wisconsin }  
County of Lafayette } ss.

History of original corner establishment:  
No evidence of any previous corner.

I Glen Barker, do hereby certify that on the 4th day of May, 19 83, I ~~found~~ found evidence of the SW 1/16 corner of Section 4 Township 33, North, Range 9 East, Fourth Principal Meridian, as described hereon; and that from this evidence I established a new monument and accessories as described hereon to perpetuate the original location of this corner.

Description of corner evidence found:  
Corner established by subdivision of the SW 1/4.  
SW 1/16 sets 1340.87 ft. of W.C. 1/16 and 1334.77 ft. of SC 1/16.

Resident witnesses:

J. Claflin - R.L.S.  
H. Wagoner

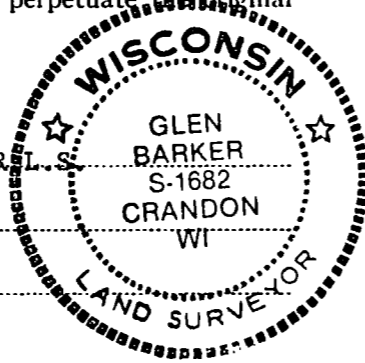

Description of monument and accessories I established to perpetuate the original location of this corner.  
Set a 2" iron pipe with brass cap stamped: T33N R9E  
Monument projects 18" above ground. S 4  
Marked NBTs: SW 1/16  
Cherry 5" S90E 16.71 ft.  
Maple 10" N33W 16.05 ft. S1682 - 1983  
Scribed 1/16 - B.T.

FORM 985  
H. C. Miller Company  
Stock No. 26272

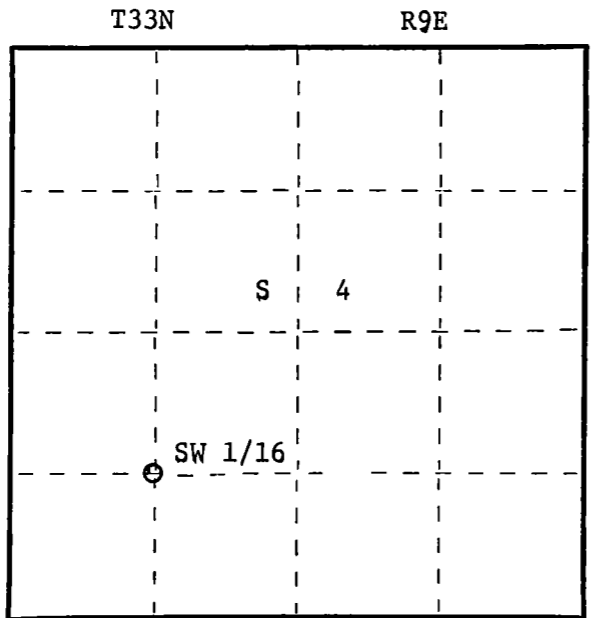

○ = Corner monument restored.

Dated at Rhineland, Wis., this 9th day of June, 19 83

Signature Glen Barker Title Registered Land Surveyor Registration No. S1682  
(County Surveyor, Registered Land Surveyor, or other duly authorized official)

Office of Register of Deeds, County of \_\_\_\_\_, I hereby certify that the within instrument was filed in this office for record on the \_\_\_\_\_ day of \_\_\_\_\_, 19 \_\_\_\_\_ at \_\_\_\_\_ o'clock \_\_\_\_\_ M.

(Register of Deeds)

By \_\_\_\_\_ Deputy