

CERTIFIED LAND CORNER RESTORATION

Index No. B-14

State of Wisconsin }
County of Langlade } ss.

History of original corner establishment:
No evidence of any previous corner.

I Glen Barker, do hereby
certify that on the 10th day
of May, 1983, I ~~found~~ found estab'd
~~evidence of~~ the NW 1/16
corner of Section 3
Township 33, North, Range
9 East, Fourth Principal Meridian,
as described hereon; and that from this evidence
I established a new monument and accessories
as described hereon to perpetuate the original
location of this corner.

Description of corner evidence found:
Corner established by subdivision of the NW 1/4.
NW 1/16 sets 1306.59 ft. of NC 1/16 and 1314.70 ft. of WC 1/16.

Resident witnesses:

J. Claflin - R.L.S.

H. Wagoner

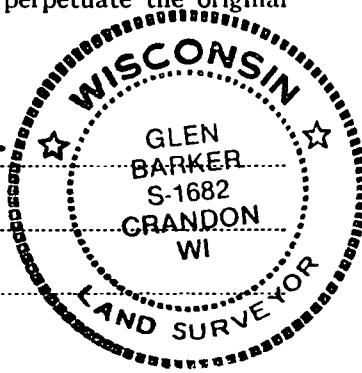

Description of monument and accessories I established to perpetuate the original location of this corner.

Set a 1" iron pipe with 2" diameter alloy cap stamped: S1682
Monument projects 18" above ground. T33N R9E
Marked NBTs S 3
Cedar 7" S68W 20.11 ft. NW 1/16
Cedar 11" N17E 44.99 ft.
Scribed 1/16 - B.T. CPI - 1983

McMillan Company
FORM 985
Stock No. 26272

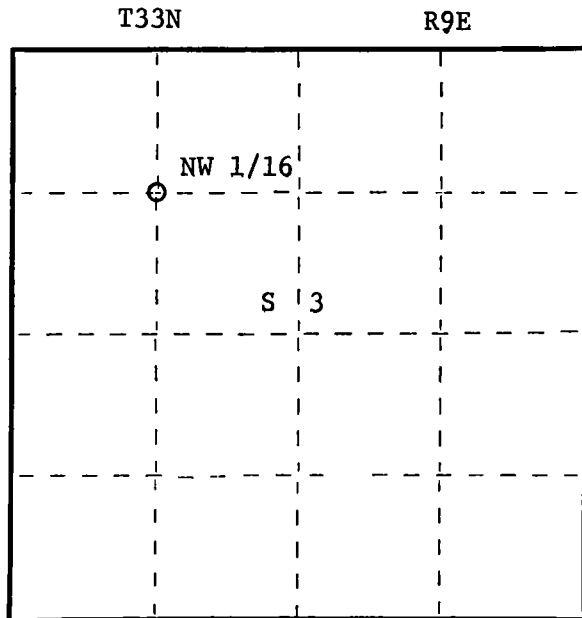

○ = Corner monument restored.

Dated at Rhinelander, Wis., this 9th day of June, 1983

Signature Glen Barker Title Registered Land Surveyor Registration No. S1682
(County Surveyor, Registered Land Surveyor, or other duly authorized official)

Office of Register of Deeds, County of _____, I hereby certify that the within
instrument was filed in this office for record on the _____ day of _____, 19____
at _____ o'clock _____ M.

(Register of Deeds)

By _____ Deputy