

CERTIFIED LAND CORNER RESTORATION

Index No. **E-23**

State of Wisconsin }
County of Lanola } ss.

History of original corner establishment:

33-9

I Raymond J. Hallisy, do hereby certify that on the 8th day of April, 1979, I found evidence of the 1/4 corner of Section 1 & 12 Township 33, North, Range 9E, Fourth Principal Meridian, as described hereon; and that from this evidence I established a new monument and accessories as described hereon to perpetuate the original location of this corner.

Corner set in the 1930 resurvey.

*5/5/99 D. TUSTY
W.M. ON N. SIDE OF ROAD IN
GOOD CONDITION.
SET SIGN POST 0.5' WEST OF W.M.*

Description of corner evidence found:

4" pipe with brass cap, Witness corner.

Resident witnesses:

.....
.....
.....

Description of monument and accessories I established to perpetuate the original location of this corner.

New BT's *To witness corner*

- 10" Hard Maple S9E 57.9 Ft.
- 6" Ironwood So 62.3 Ft.
- 16" Hard Maple N85W 15.7 Ft.

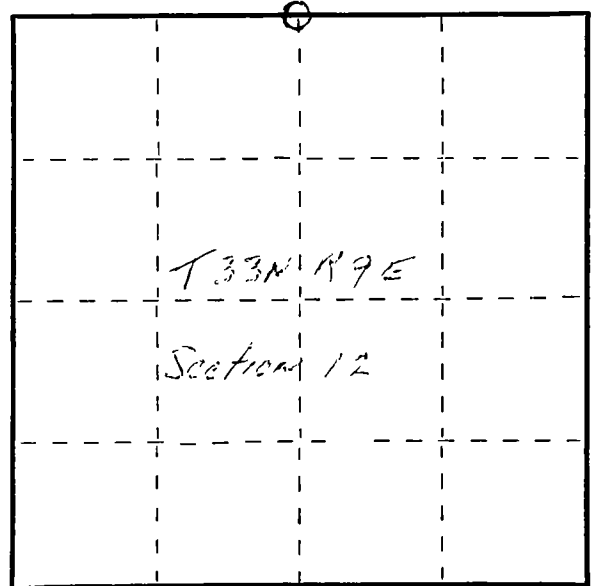
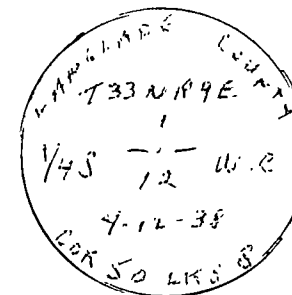

○ = Corner monument restored.

Dated at Antigo, Wis., this 8th day of April, 1979.

Signature Raymond J. Hallisy Title Reg. Surveyor Registration No. S-685
(County Surveyor, Registered Land Surveyor, or other duly authorized official)

Office of Register of Deeds, County of _____, I hereby certify that the within instrument was filed in this office for record on the _____ day of _____, 19____ at _____ o'clock _____ M.

.....
(Register of Deeds)

By..... Deputy