

CERTIFIED LAND CORNER RESTORATION

Index No. 224

32-14

State of Wisconsin }
County of LANGLADE } ss.

I WILLIAM F. KELLY, do hereby certify that on the 15th day of MARCH, 1983, I found evidence of the E. 1/4 corner ON N. LINE OF SECT. 1 Township 31, North, Range 14 EAST, Fourth Principal Meridian, as described hereon; and that from this evidence I established a new monument and accessories as described hereon to perpetuate the original location of this corner.

Resident witnesses:

History of original corner establishment:
CORNER NOT ESTABLISHED DURING ORIGINAL GOVERNMENT SURVEY.

Description of corner evidence found:
SET 2" x 36" ALUMINUM MONUMENT ON LINE & AT MIDPOINT BETWEEN N 1/4 CORNER & NE CORNER OF SECT. 1.



William F. Kelly

Description of monument and accessories I established to perpetuate the original location of this corner.

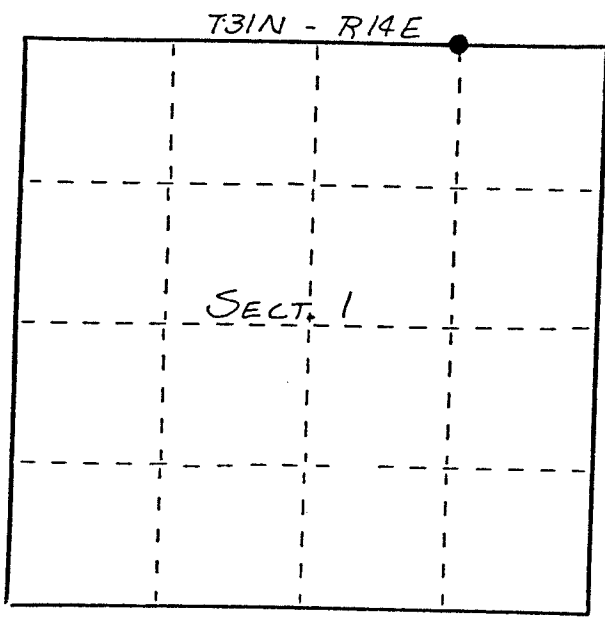
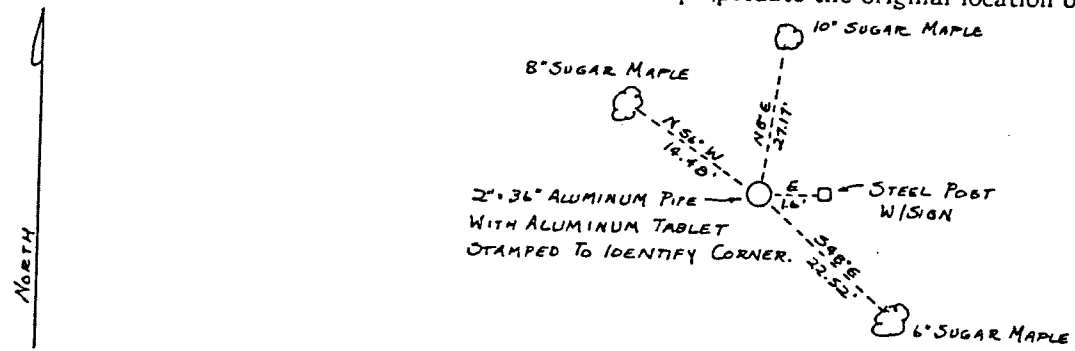

○ = Corner monument restored.

Dated at ELCHO, Wis., this 15th day of MARCH, 1983.

Signature William F. Kelly Title COUNTY SURVEYOR Registration No. 1098
(County Surveyor, Registered Land Surveyor, or other duly authorized official)

Office of Register of Deeds, County of _____, I hereby certify that the within instrument was filed in this office for record on the _____ day of _____, 19____ at _____ o'clock _____ M.

(Register of Deeds)

By _____ Deputy

McMillan Company
Surveyors' Products

FORM 500 - 1-7-1982