

CERTIFIED LAND CORNER RESTORATION

Index No. L-11

State of Wisconsin }
 County of Laclede } ss.

I Daniel K. Plegger, do hereby certify that on the 29th day of April, 1980, I found evidence of the Center corner of Section 16 Township 32 North, Range 14 East, Fourth Principal Meridian, as described hereon; and that from this evidence I established a new monument and accessories as described hereon to perpetuate the original location of this corner.

Resident witnesses:

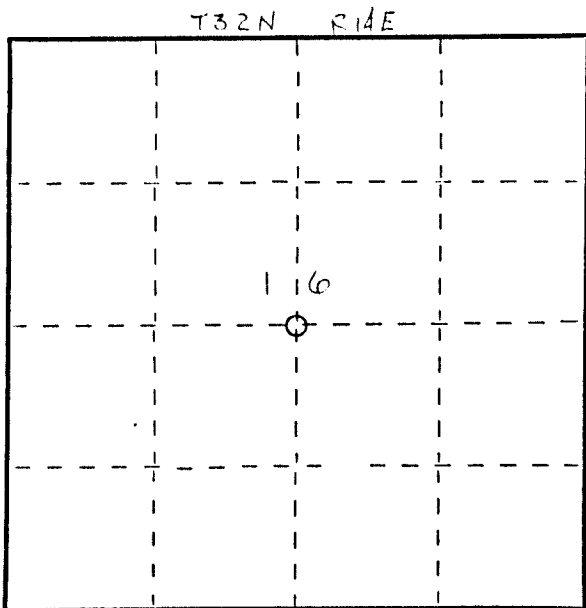
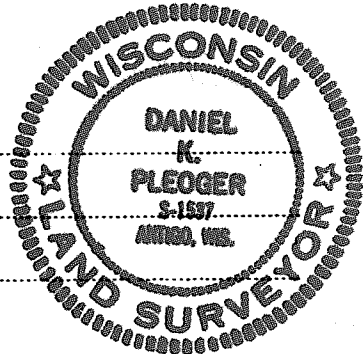

○ = Corner monument restored.

History of original corner establishment:

Center of Section 16 was set by M. Hutchinson on December 2, 1916.
 His BT's were: Birch 12 S45W 2 1/2
 Hemlock 18 N4E 5 1/2

Description of corner evidence found:

We could find no evidence of Hutchinson's corner or BTs. Residents said area had been badly burned twice since corner had been set. We reset Center of Section 16 by proportioning our distance on N-S 1/4 line to Hutchinson's distances from N 1/4 corner and S 1/4 Corner to Center. Our total distance, 5279.86'; checks close to Hutchinson's distance, 5289.9'. Our distance from N 1/4 to Center = 2644.22'; S 1/4 to Center = 2635.64'.

Description of monument and accessories I established to perpetuate the original location of this corner.

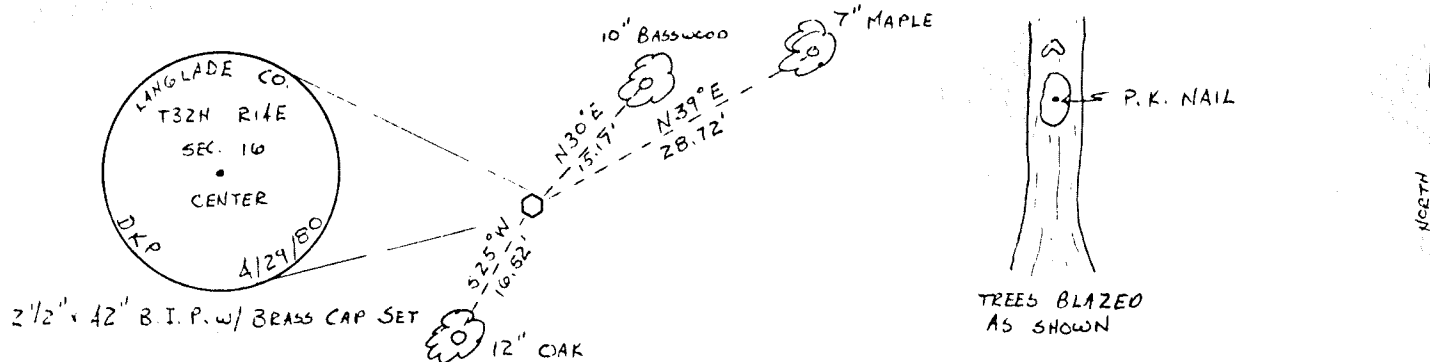

Dated at Antigo, Wis., this 2nd day of June, 1980.

Signature Daniel K. Plegger Title Registered Land Surveyor Registration No. 1537
 (County Surveyor, Registered Land Surveyor, or other duly authorized official)

Office of Register of Deeds, County of _____, I hereby certify that the within instrument was filed in this office for record on the _____ day of _____, 19____ at _____ o'clock _____ M.

(Register of Deeds)

By _____ Deputy

FORM 985 W. C. MILLER CO., MILWAUKEE