

U.S. PUBLIC LAND SURVEY MONUMENT RECORD

(As Required By s. A-E 5.02, WI Adm. Code)

History of original corner establishment and subsequent restorations and description of any record, monument, occupational, testimonial or other evidence considered:

In 1857, A. Millard, Dep. Surveyor, set post and established 2 B.T.s; an Ironwood 8" N.33°W. 23 lks. and a Sugar 11" S.70°E. 6 lks.

No further record evidence was found;

In 1991, I found an ancient fence corner with fences running N., E. & W. from corner, found no evidence of original corner stake or accessories. According to local residents this fence corner has been the property corner for as long as any remember.

Corner was: (Check All That Apply)

- Restored through acceptance of an obliterated evidence location
- Restored through acceptance of a found perpetuated location
- Considered a lost corner and reestablished through lost corner proportionate methods (include a plan view drawing showing distances and directions to other Public Land Survey Corners used for proportioning and determining the corner location)
- Restored or reestablished in a location that differs from a previous restoration or reestablishment (include a plan view drawing and indicate what was set and/or found)

Describe the monument and accessories used to perpetuate the location of this corner. (include a plan view drawing and indicate what was set and/or found)

I accept a point 1' South of the center of the fence corner post as the best remaining evidence of the corner location and set a 2½" alum. post with cap at this location; referenced as shown below.

The N. ¼
corner of Section 18 ,
T. 32 N., R. 14 E.,
Fourth Principal Meridian,

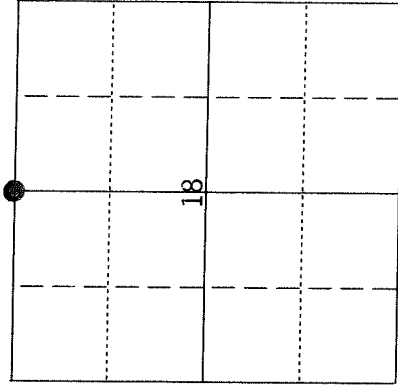

● = Location of Corner

I, James J. Fronsoe S-1381
(type or print name) certify that the corner location shown on this record was determined by me or under my direction and control and that this U.S. Public Land Survey Monument Record is correct and complete to the best of my knowledge and belief.

Signature James J. Fronsoe Date 8/16/91

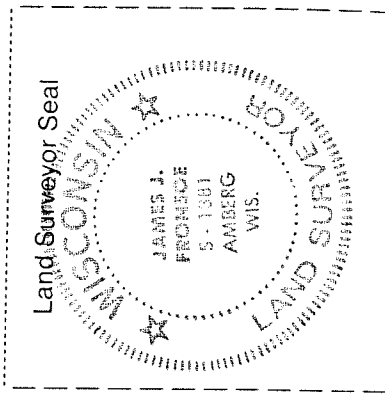
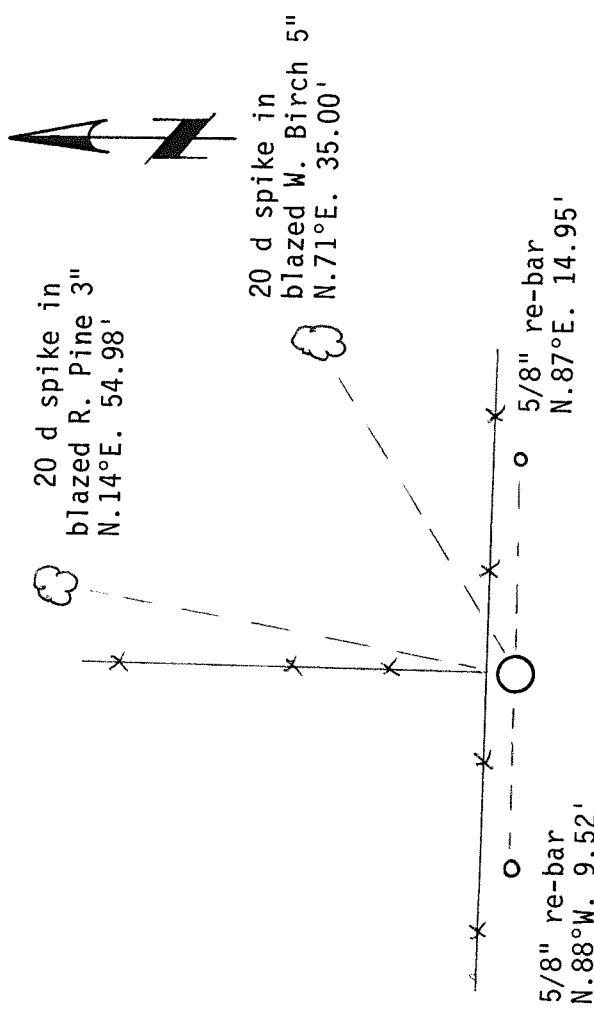

Index No. J-3