

CERTIFIED LAND CORNER RESTORATION

Index No. J-5

State of Wisconsin }
County of LANGLADE } ss.

History of original corner establishment:

SURVEY BY A. MILLAND IN 1857

NORTH BETWEEN SECTIONS 17 & 18
80.0CHS. SET POST
CORNER TO SECTIONS 7-8-17-18
B.T. SUGAR 12" N.50°E. 22LKS.
B.T. LYNN 12" S.68°W. 34LKS.

I WAYNE G. DOBBRATZ, do hereby
certify that on the 17TH day
of JANUARY 1980, I found
evidence of the NORTHWEST
corner of SECTION 17
Township 32, North, Range
14 EAST, Fourth Principal Meridian,
as described hereon; and that from this evidence
I established a new monument and accessories
as described hereon to perpetuate the original
location of this corner.

Description of corner evidence found:

FOUND OLD IRON AXLE

Resident witnesses:

Description of monument and accessories I established to perpetuate the original location of this corner.

SET STANDARD LANGLADE COUNTY MONUMENT 2"X 42" BRASS
CAPPED IRON PIPE.

WITNESS

"A"=R.R. SPIKE IN TREE S.47°-54'W. 8.30FT.

"B"=R.R. SPIKE IN TREE N.61°-44'W. 21.55FT.

"C"=R.R. SPIKE IN TREE S.32°-39'E. 15.09FT.

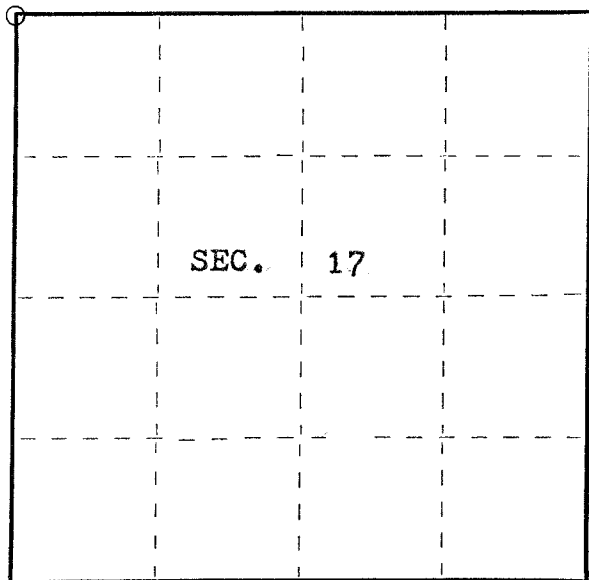
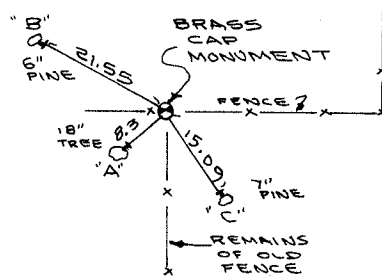
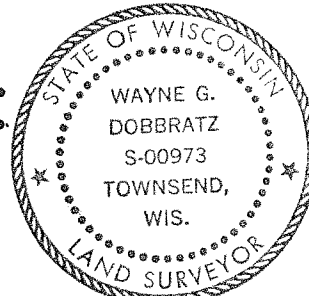

Dated at TOWNSEND, Wis., this 22ND day of JANUARY, 1980

Signature Wayne G. Dobbratz Title LAND SURVEYOR Registration No. 973
(County Surveyor, Registered Land Surveyor, or other duly authorized official)

Office of Register of Deeds, County of....., I hereby certify that the within
instrument was filed in this office for record on the.....day of....., 19.....
at.....o'clock..... M.

(Register of Deeds)

By.....Deputy

○ = Corner monument restored.