

CERTIFIED LAND CORNER RESTORATION

31-13 (1) A-22  
Index No. [REDACTED]

State of Wisconsin }  
County of LANGLADE } ss.

I, RAYMOND J. HALLISY, JR., do hereby certify that on the TWENTY SEVEN day of MAY, 1964, I found evidence of the SEVERAL CORNERS corner of SECTION 36 Township 32, North, Range 13 EAST, Fourth Principal Meridian, as described hereon; and that from this evidence I established a new monument and accessories as described hereon to perpetuate the original location of this corner.

History of original corner establishment:

1850 ORIGINAL SURVEY NOTES - 1859  
RESURVEY NOTES - 1914

LOCATION OF ABOVE DATA FOUND IN  
LANGLADE CITY COURTHOUSE

- (1) V-21
- (2) X-21
- (3) Z-21
- (4) Z-22
- (5) Z-23
- (6) Z-24
- (7) Z-25

Description of corner evidence found:

SEE BACK OF PAGE UNDER "A"

Resident witnesses:

CORNERS LISTED NUMERICALLY AS  
INDICATED BY SECTION DIAGRAM

Description of monument and accessories I established to perpetuate the original location of this corner.

SEE BACK OF PAGE UNDER "B"

CORNERS LISTED NUMERICALLY AS  
INDICATED BY SECTION DIAGRAM

FORM 985 H. C. MILLER CO., MILWAUKEE

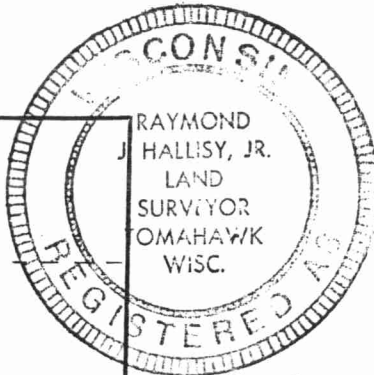
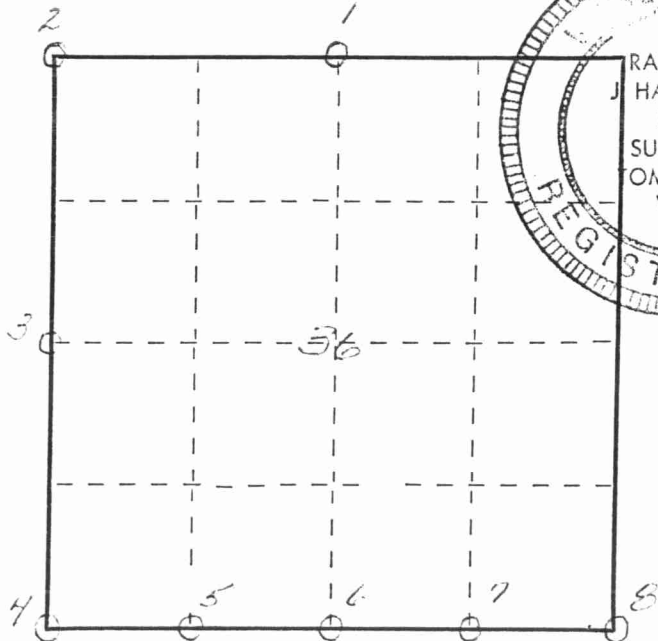

Dated at ANTIGO, Wis., this JUNE day of 1964

Signature Raymond J. Hallisy, Jr. Title REG. LAND SURVEYOR Registration No. 5-685  
(County Surveyor, Registered Land Surveyor, or other duly authorized official)

Office of Register of Deeds, County of \_\_\_\_\_, I hereby certify that the within instrument was filed in this office for record on the \_\_\_\_\_ day of \_\_\_\_\_, 19\_\_\_\_ at \_\_\_\_\_ o'clock \_\_\_\_\_ M.

(Register of Deeds)

By \_\_\_\_\_ Deputy

○ = Corner monument restored.

"A"

"B"

OLD EVIDENCE

NEW EVIDENCE

CORNERS

ORIGINAL HEINRICH B.T.

SQUARED "ELM" Post

#1) N  $\frac{1}{4}$  CORNER

OLD POINT

NEW B.T. 16" HD MAPLE N64°E - 20 FT

#2) NW SEC CORNER

SCRIBED CEDAR Post  
AND B.T.S

NONE

#3) W  $\frac{1}{4}$  CORNER

Rock HEARD AND  
REMAINS OF OLD WOOD Post

SQUARED IRON WOOD Post  
NEW B.T.S 14" HD MAPLE - 57°E - 41.7 LINKS  
18" HD MAPLE 58°W - 42.5 "

#4) SW SEC CORNER

SQUARED Post AND  
SQUARED WITNESS TREE

SQUARED IRON WOOD Post  
NEW B.T.S 14" ELM - 516°W 23 LINKS  
8" BIT NOT HICKORY N45°W 16.7 "  
6" HD MAPLE N46°E 26.6 "

#5) W  $\frac{1}{16}$  CORNER

NONE

SQUARED BITTERNOT HICKORY Post  
NEW B.T.S 6" BIT NOT HICKORY 571°E 14.2 LINKS  
8" HD MAPLE - N48°W 31.5 "

#6) S  $\frac{1}{4}$  CORNER

NONE

SQUARED Post  
NEW B.T.S 11" ELM 521°E 28.5 LINKS  
14" HD MAPLE 549°W 49 LINKS

#7) E  $\frac{1}{16}$  CORNER

NONE

SQUARED Post  
NO B.T.S - NO SUITABLE TIMBER CLOSE  
AT HAND

#8) SE SEC CORNER

SQUARE Post  
IN ROCK HEARD  
OLD B.T.S

NEW B.T.S 12" HD MAPLE 515°W 43 LINKS  
16" HD MAPLE 530°E 6.1 LINKS

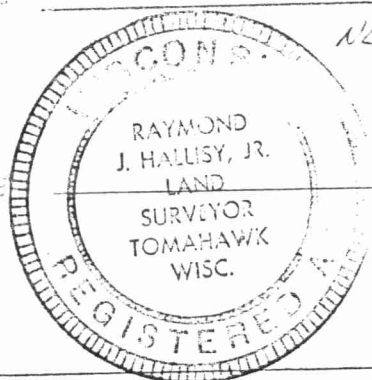

ALL B.T.S (BEARINGS) DESCRIBED WITH COMPASS SET ON 0° (MAGNETIC)

PERSONNEL W.C.D.

RAYMOND J. HALLISY, JERRY KRYKA, STAN ZARASH  
LANGLADE CTY CHRISTY HAUGE, GENE MCKENNA, JERRY WELIX