

CERTIFIED LAND CORNER RESTORATION

32-13
Index No. V-21

State of Wisconsin }
County of Langlade } ss.

I, Raymond J. Hallisy, do hereby certify that on the 29th day of June, 1968, I found evidence of the NW Section Corner corner of Section 36 Township 32 N, North, Range 13 E, Fourth Principal Meridian, as described hereon; and that from this evidence I established a new monument and accessories as described hereon to perpetuate the original location of this corner.

Resident witnesses:

J. Weix

G. Kryka

History of original corner establishment:

Original survey 1859
Resurvey 1914

Description of corner evidence found:

June 1964: Found scribed cedar post and BT'S
14" Hard maple S 29° E
Possible 12" Basswood S70°W

Post scribed Sec26 Sec25
Sec35 Sec36

Description of monument and accessories I established to perpetuate the original location of this corner.

Set standard brass cap in cement;
marked as shown below:

New BT'S 8" Elm N37°W 20' 8"
9" Hard maple S24°W 24' 2"

- 5/4" BT
- BRASS CAP
- MAPLE BT

FORM 985 H. C. MILLER CO., MILWAUKEE

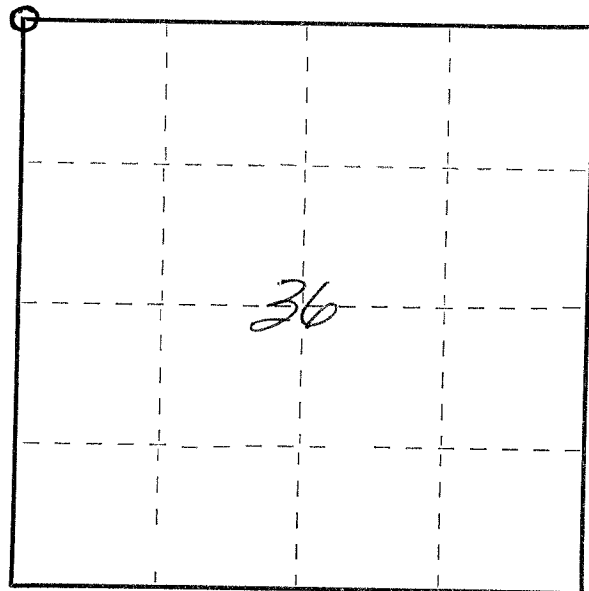

○ = Corner monument restored.

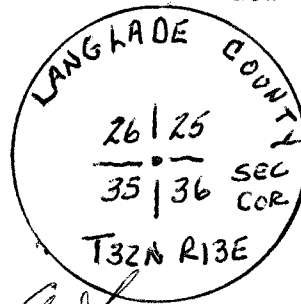

Dated at Antigo, Wis., this 31 day of August, 1968

Signature: Raymond J. Hallisy, Reg. Land Surveyor
County Surveyor, Registered Land Surveyor, or other duly authorized official. Registration No. S-685

Office of Register of Deeds, County of _____, I hereby certify that the within instrument was filed in this office for record on the _____ day of _____, 19____ at _____ o'clock _____ M.

(Register of Deeds)

By _____ Deputy