

CERTIFIED LAND CORNER RESTORATION

92-13 (1) V-23  
Index No.

State of Wisconsin }  
County of LANGLADE } ss.

History of original corner establishment:

I RAYMOND J. HALLISY, do hereby certify that on the MONTH OF MAY day of MAY, 1964, I found evidence of the SEVERAL CORNERS corner of SECTION 36 Township 32, North, Range 12 EAST, Fourth Principal Meridian, as described hereon; and that from this evidence I established a new monument and accessories as described hereon to perpetuate the original location of this corner.

USED ORIGINAL SURVEY NOTES - 1859  
RESURVEY NOTES - 1914  
LOCATION OF ABOVE DATA FOUND IN  
LANGLADE CITY COURTHOUSE

- (2) V-21
- (3) X-21
- (4) Z-21
- (5) Z-22
- (6) Z-23
- (7) Z-24
- (8) Z-25

Description of corner evidence found:

SEE BACK OF PAGE UNDER "A"  
CORNERS LISTED NUMERICALLY AS  
INDICATED BY SECTION DIAGRAM

Resident witnesses:

Description of monument and accessories I established to perpetuate the original location of this corner.

SEE BACK OF PAGE UNDER "B"  
CORNERS LISTED NUMERICALLY AS  
INDICATED BY SECTION DIAGRAM

FORM 985 H. C. MILLER CO., MILWAUKEE

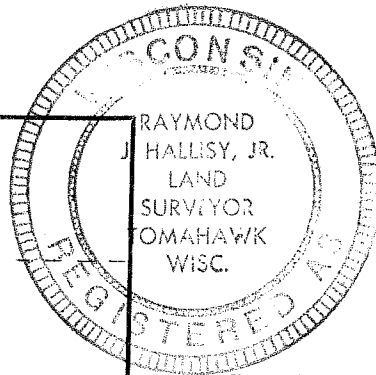
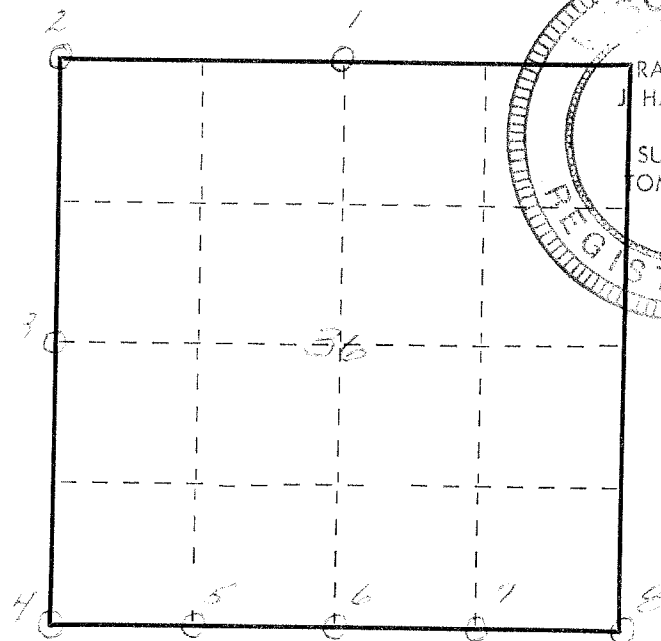

Dated at ANTIGO, Wis., this NINE day of JUNE, 1964

Signature Raymond J. Hallisy Title ASSY. DISTRICT FORESTER - WCD Registration No. 5-685  
(County Surveyor, Registered Land Surveyor, or other duly authorized official)

Office of Register of Deeds, County of LANGLADE, I hereby certify that the within instrument was filed in this office for record on the        day of       , 19       at        o'clock        M.

(Register of Deeds)

By        Deputy

○ = Corner monument restored.

4/27/09 D.T. Roy Zubrod Reported THAT ALL EVIDENCE OF THE N 1/4 CORNER IS GONE.

CORNERS	OLD EVIDENCE	NEW EVIDENCE
#1) N 1/4 CORNER	ORIGINAL HENRICK B.T. OLD POINT	SQUARED " ELM POST NEW B.T. 16" HD MAPLE N 67° E - 20 FT
#2) NW 1/4 CORNER	SCRIBED CEDAR POST AND B.T.S	NONE
#3) W 1/4 CORNER	ROCK MOUND AND REMAINS OF OLD WOOD POST	SQUARED IRON WOOD POST NEW B.T.S 14" HD MAPLE - S 71° E - 41.7 LINKS 12" HD MAPLE S 87° W - 42.5 "
#4) SW 1/4 CORNER	SQUARED POST AND SQUARED WITNESS TREE	SQUARED IRON WOOD POST NEW B.T.S 14" ELM - S 16° W 23 LINKS 5" BIT NOT HICKORY N 48° W 16.7 " 6" HD MAPLE N 46° E 26.6 "
#5) W 1/16 CORNER	NONE	SQUARED BIT NOT HICKORY POST NEW B.T.S 6" BIT NOT HICKORY S 71° E 14.2 LINKS 5" HD MAPLE - N 48° W 21.5 "
#6) S 1/4 CORNER	NONE	SQUARED POST NEW B.T.S 11" ELM S 21° E 28.2 LINKS 14" HD MAPLE S 49° W 49 LINKS
#7) E 1/16 CORNER	NONE	SQUARED POST NO B.T.S - NO SOUTHERLY TIMBER GROWN AT HAND
#8) SE 1/4 CORNER	SQUARED POST IN ROCK MOUND OLD B.T.S	NEW B.T.S 12" HD MAPLE S 15° W 43 LINKS 16" HD MAPLE S 30° E 61 LINKS

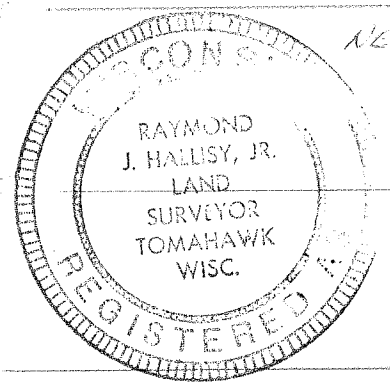

All B.T.S (Bearings) Described with Compass set at 0° (MAGNETIC)

PERSONNEL W.C.D.

RAYMOND J. HALLISY, JERRY KAYRA, STAN ZARASH  
LARGANGE CITY CHRISTY HADGE, GORD MCKENNA, JERRY W. GIX