

CERTIFIED LAND CORNER RESTORATION

32-13 Index No. P-21

State of Wisconsin }
County of Langlade } ss.

History of original corner establishment:

I Raymond J. Hallisy, do hereby certify that on the 20th day of July, 1968, I found evidence of the W 1/4 corner of Section 24 Township 32, North, Range 13, Fourth Principal Meridian, as described hereon; and that from this evidence I established a new monument and accessories as described hereon to perpetuate the original location of this corner.

Description of corner evidence found:

Found squared stake down, old Yellow Birch BT 41" N38E 8 Lks Blazed lines from East, South, and West

Resident witnesses:

.....
.....
.....

Description of monument and accessories I established to perpetuate the original location of this corner.

Set Brass Cap in cement 3' deep 4" thick and 1 1/2' above ground

FORM 985 H. C. MILLER CO., MILWAUKEE

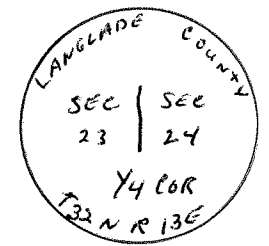
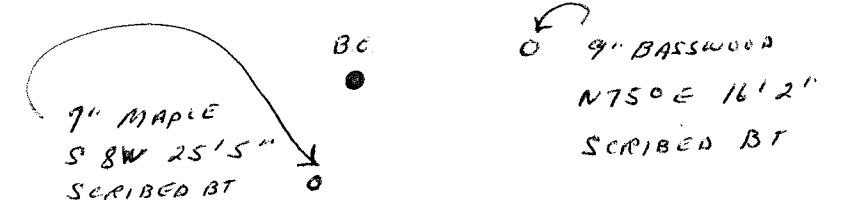
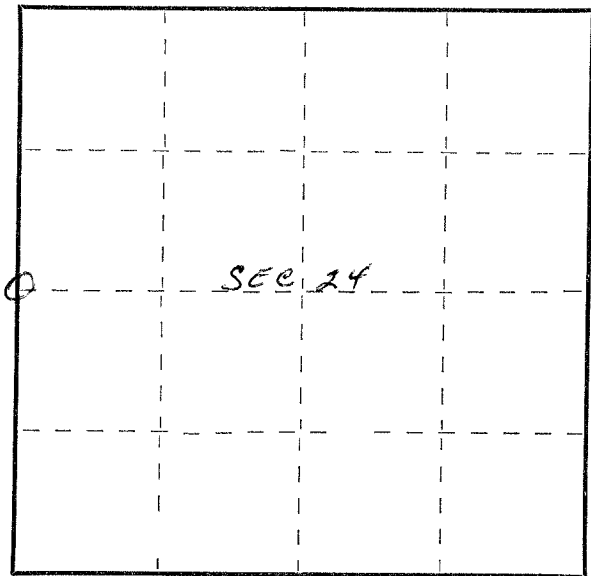

Dated at Antigo, Wis., this 20th day of July, 1968

Signature Raymond J. Hallisy Title Reg Land Surveyor Registration No. S-685
(County Surveyor, Registered Land Surveyor, or other duly authorized official)

Office of Register of Deeds, County of _____, I hereby certify that the within instrument was filed in this office for record on the _____ day of _____, 19____ at _____ o'clock _____ M.

(Register of Deeds)

○ = Corner monument restored.

By _____ Deputy