

CERTIFIED LAND CORNER RESTORATION

Index No. M-25

State of Wisconsin }  
County of LANGLADE } ss.

History of original corner establishment:

I WILLIAM F. KELLY, do hereby certify that on the 20 day of OCTOBER, 1978, I found evidence of the E 1/8 corner of SE 1/4 SECTION 13 Township 32, North, Range 13E, Fourth Principal Meridian, as described hereon; and that from this evidence I established a new monument and accessories as described hereon to perpetuate the original location of this corner.

Resident witnesses:

.....  
.....  
.....

Description of corner evidence found:  
FOUND 4" X 4" WOODEN POST & OLD BEARING TREES.

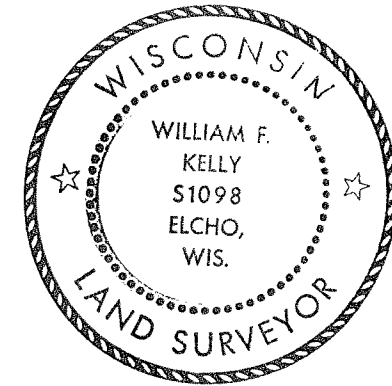

*William F. Kelly*

Description of monument and accessories I established to perpetuate the original location of this corner.  
SET 1 1/2" X 42" IRON PIPE WITH BRASS CAP & RE-SCRIBED FOUND B.T.S.

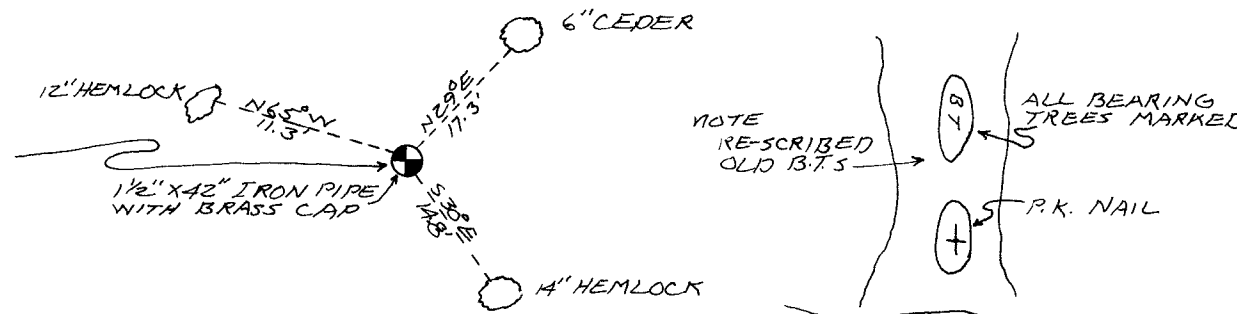
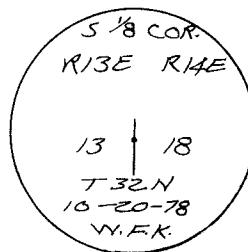
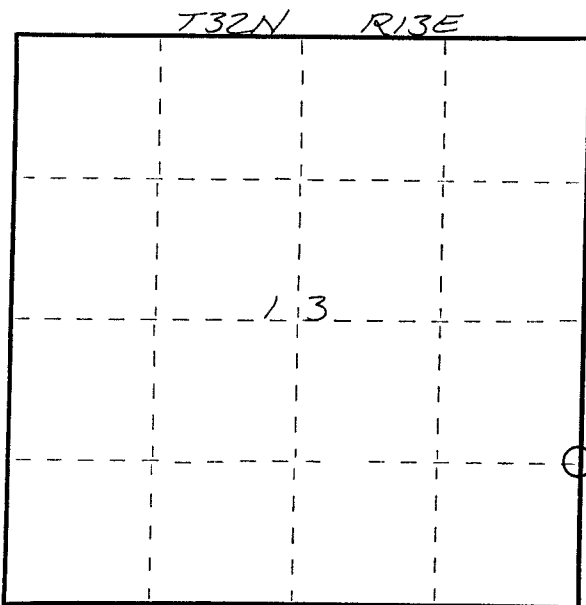

Dated at ELCHO, Wis., this 7 day of DECEMBER, 1978.

Signature William F. Kelly Title COUNTY SURVEYOR Registration No. S-1098  
(County Surveyor, Registered Land Surveyor, or other duly authorized official)

Office of Register of Deeds, County of \_\_\_\_\_, I hereby certify that the within instrument was filed in this office for record on the \_\_\_\_\_ day of \_\_\_\_\_, 19\_\_\_\_ at \_\_\_\_\_ o'clock \_\_\_\_\_ M.

.....  
(Register of Deeds)

By \_\_\_\_\_ Deputy

○ = Corner monument restored.