

CERTIFIED LAND CORNER RESTORATION

32-12

Index No. X-21

State of Wisconsin }  
County of Langlade } ss.

History of original corner establishment:

CORNER SET in The early 1900's by M. Hutchinson

I Raymond S. Hallisy do hereby certify that on the 16th day of October, 1971, I found evidence of the 1/4 CORNER corner of Section 35 & 36 Township 32, North, Range 12E, Fourth, Principal Meridian, as described hereon; and that from this evidence I established a new monument and accessories as described hereon to perpetuate the original location of this corner.

Description of corner evidence found:

Found point of his old stake, also his 1/32 corner 10 chains South.

Resident witnesses:

Description of monument and accessories I established to perpetuate the original location of this corner.

Set 2" pipe with Brass cap

New BT's

Hard Maple 4" N22E 61x5

ELM 12" N76E 28x5

BT's faced at base of tree and scribed BT

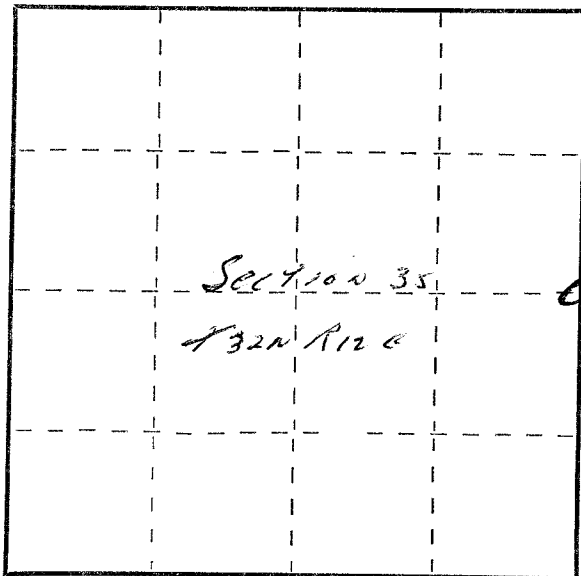
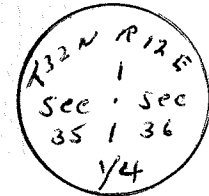

○ = Corner monument restored.

Dated at Antigo Wis., this 16th day of October, 1971.

Signature Raymond S. Hallisy Title Reg Land Surveyor Registration No. 5685  
(County Surveyor, Registered Land Surveyor, or other duly authorized official)

Office of Register of Deeds, County of \_\_\_\_\_, I hereby certify that the within instrument was filed in this office for record on the \_\_\_\_\_ day of \_\_\_\_\_, 19\_\_\_\_ at \_\_\_\_\_ o'clock \_\_\_\_\_ M.

(Register of Deeds)

By \_\_\_\_\_ Deputy