

U.S. PUBLIC LAND SURVEY MONUMENT RECORD

(Prepared and as required by S. A-E 7.08 WI Administrative Code)

The North 1/4 corner of Section 30, T. 32 N., R. 12 E., Langlade County, WI

Corner was: (check all that apply)

- Restored through acceptance of an obliterated evidence location.
- Restored through acceptance of a found perpetuated location.
- Determined to be lost and re-established through proportionate methods.
(Show bearings and distances to PLSS corners used for proportionating.)
- Restored/recovered/reestablished in a location that differs from a previously established position. (Show difference in plan view below.)
- Check here if additional information is shown on the reverse side of this form.

Describe record evidence, recovered physical evidence, occupational evidence, testimonial evidence and all other evidence considered in the recovery/restoration of the corner.

Monument was set at the location of an East-West fence line and a fence line leading north as reported by Maly who owns lands to the northwest and to the southeast. They removed old fence and put a farm road on the fence line leading north. I set a monument on the east-west fence line and the center of the farm road.
Original survey by James McBride in 1857. At that time ties were Sugar 8 S61W 21 lks and Sugar 12 N62W 28 lks. No other information can be located on the this corner.

Physical description of the monument set:

Set a 2" iron pipe monument with brass cap 8" below the grade of the farm road. I stamped the cap to identify the corner.

Describe the accessories used to perpetuate the location of the corner. Include a plan view drawing and indicate accessories found/set. Describe measuring point on bearing trees. Show any topographic features that would aid in future recovery of the corner.

W.C.'s are 3/4 rebar with a red cap. A plastic post (-1) was set as indicated.

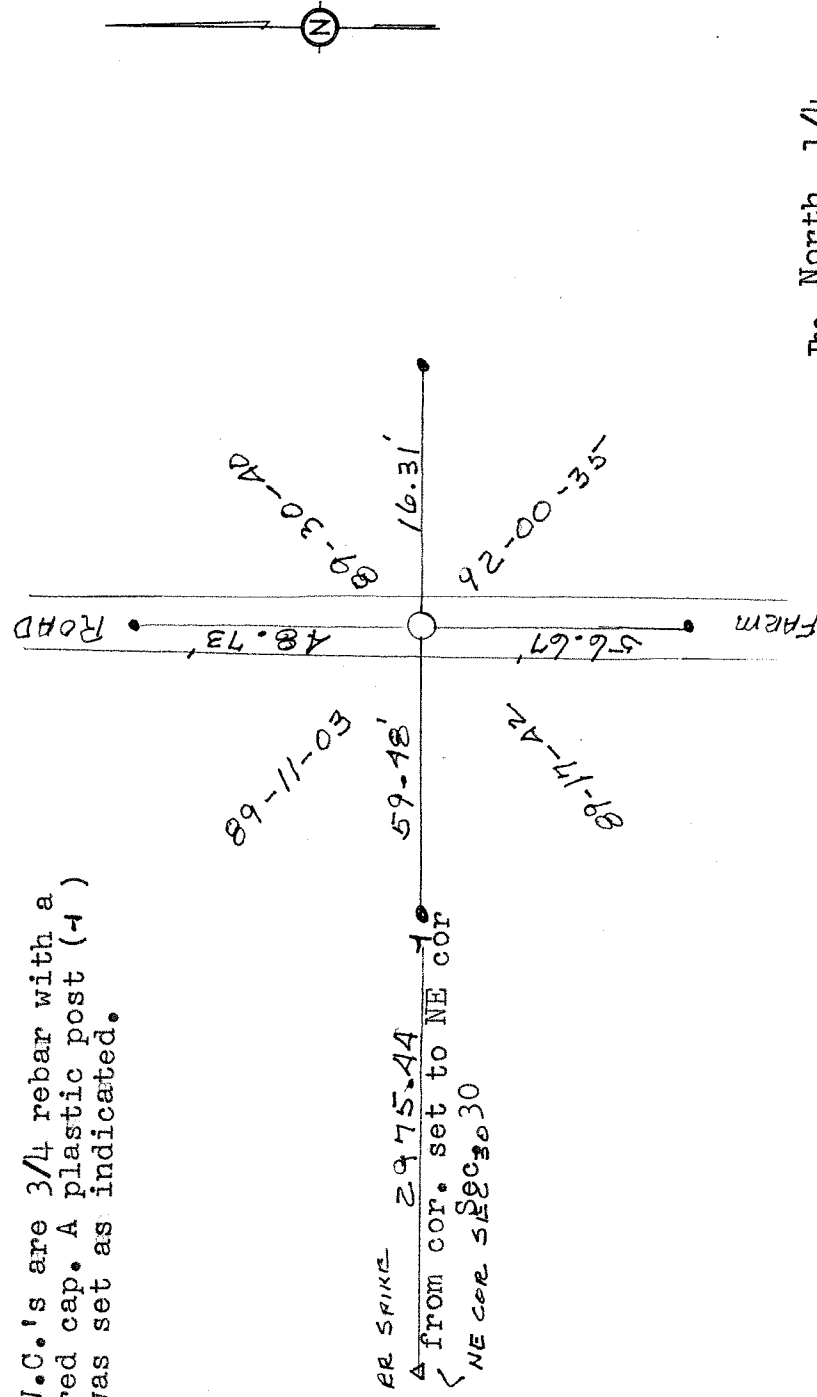

BR STRIKE 2975.44
A from cor. set to NE cor
NE cor. S88C3030

SURVEYORS SEAL

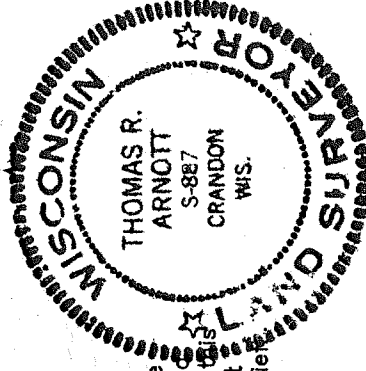

I, Thomas Arnott, certify that the corner location shown on this record was determined by me or under my direction and control and that this U.S. Public Land Survey Monument Record is correct and complete to the best of my knowledge and belief.

Thomas Arnott
Signature

6 Nov 1998 Date

The North 1/4 corner of Section 30, T. 32 N., R. 12 E., Langlade County, WI

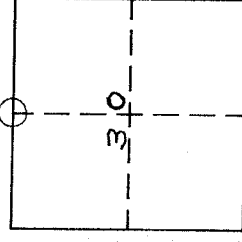

○ = Location of corner

INDEX No. R3

3212190020