

CERTIFIED LAND CORNER RESTORATION

92-12

Index No. N-20

State of Wisconsin }  
County of Lacrosse } ss.

I Raymond Hallisy do hereby certify that on the 12<sup>th</sup> day of May, 19 73, I found evidence of the E 1/4 corner of Section 14 & 23 Township 32, North, Range 12E, Fourth, Principal Meridian, as described hereon; and that from this evidence I established a new monument and accessories as described hereon to perpetuate the original location of this corner.

Resident witnesses:

.....  
.....  
.....

History of original corner establishment:

Corner Set in The 1930 resurvey

Description of corner evidence found:

Wood stake down, point intact.

Marked S 23, S 14, Blazed line E & W

Description of monument and accessories I established to perpetuate the original location of this corner.

Set 1 1/2" iron pipe with brass cap - Marked

New BT's

Aspen 8" N 58 W 23 FT. 11 in.

Aspen 10" N 77 E 47 FT. 9 in.

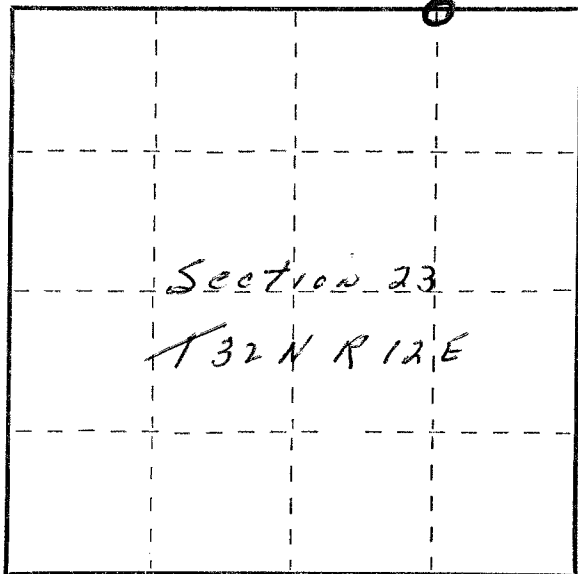
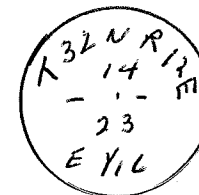

○ = Corner monument restored.

Dated at Antigo, Wis., this 12<sup>th</sup> day of May, 19 73

Signature Raymond Hallisy Title Reg. Land Surveyor Registration No. 5-685  
(County Surveyor, Registered Land Surveyor, or other duly authorized official)

Office of Register of Deeds, County of \_\_\_\_\_, I hereby certify that the within instrument was filed in this office for record on the \_\_\_\_\_ day of \_\_\_\_\_, 19 \_\_\_\_\_ at \_\_\_\_\_ o'clock \_\_\_\_\_ M.

(Register of Deeds)

By \_\_\_\_\_ Deputy