

CERTIFIED LAND CORNER RESTORATION

32-12

Index No. N-22

State of Wisconsin }
County of Langlade } ss.

History of original corner establishment:

Corner set in the 1930 resurvey.

I Raymond J. Hallisy, do hereby certify that on the 6th day of June, 1971, I found evidence of the W 1/16 corner of Section 13 7 24 Township 32 12E, North, Range 12E, Fourth, Principal Meridian, as described hereon; and that from this evidence I established a new monument and accessories as described hereon to perpetuate the original location of this corner.

Description of corner evidence found:

Found old stake down, point intact, marked W1/16 13 24

Resident witnesses:

.....
.....
.....

Description of monument and accessories I established to perpetuate the original location of this corner.

Set ~~XXXX~~ 2" pipe with brass cap

BT's to corner
10" balsam N84E 31 Feet 9 inches
8" aspen N52W 25 Feet 8 inches
BT's faced at base of tree and scribed bt.

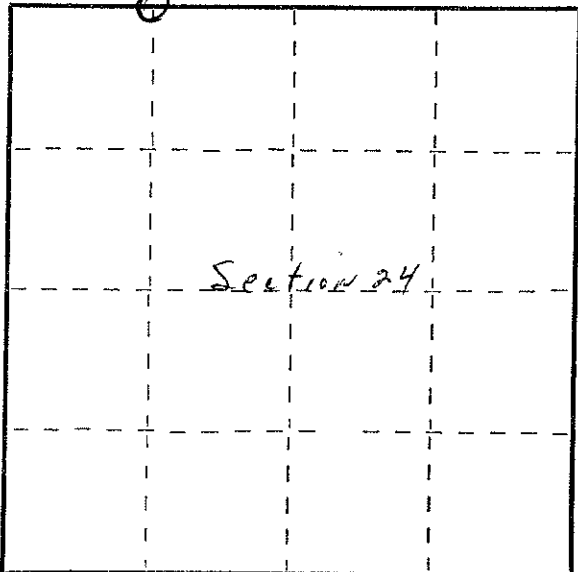

○ = Corner monument restored.

Dated at Apt 190, Wis., this 6th day of June, 1971

Signature R. J. Hallisy Title Reg. Land Surveyor Registration No. 685
(County Surveyor, Registered Land Surveyor, or other duly authorized official)

Office of Register of Deeds, County of Langlade, I hereby certify that the within instrument was filed in this office for record on the _____ day of _____, 19____ at _____ o'clock _____ M.

(Register of Deeds)

By _____ Deputy

FORM 985 H. C. MILLER CO., MILWAUKEE