

CERTIFIED LAND CORNER RESTORATION

32-12  
Index No. H-21

State of Wisconsin }  
County of Langlade } ss.

History of original corner establishment:

Corner set in the 1930's by: D. A. Hintz  
Hugh StClaire  
C. W. Borth

I Raymond J. Hallisy, do hereby  
certify that on the 13th day  
of July, 1968, I found  
evidence of the S 1/16  
corner of Section 12  
Township 32, North, Range  
12, Fourth Principal Meridian,  
as described hereon; and that from this evidence  
I established a new monument and accessories  
as described hereon to perpetuate the original  
location of this corner.

Description of corner evidence found:

Found old stake marked S 1/16 S11 S12

Resident witnesses:

.....  
.....  
.....

Description of monument and accessories I established to perpetuate the original location of this corner.  
Set Std.  $1\frac{1}{2}$ " pipe with cap marked 11 12 S1/16 rock mound

FORM 985 H. C. MILLER CO., MILWAUKEE

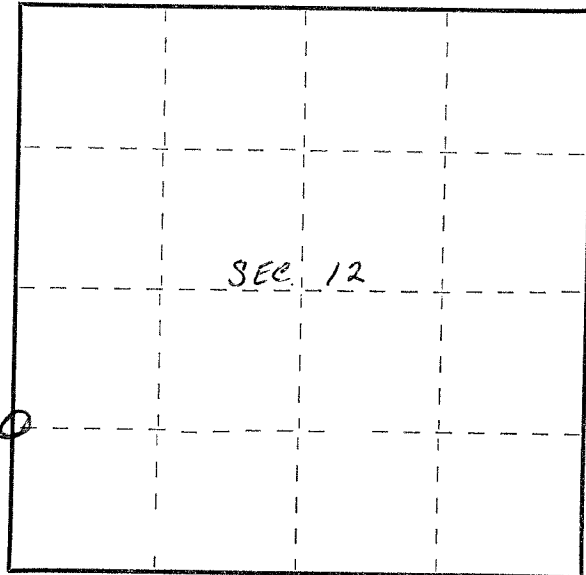

○ = Corner monument restored.

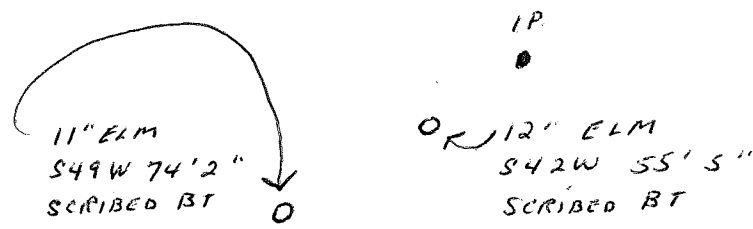

Dated at Antigo, Wis., this 13th day of July, 1968

Signature Raymond J. Hallisy Title Reg. Land Surveyor Registration No. S-685  
(County Surveyor, Registered Land Surveyor, or other duly authorized official)

Office of Register of Deeds, County of \_\_\_\_\_, I hereby certify that the within  
instrument was filed in this office for record on the \_\_\_\_\_ day of \_\_\_\_\_, 19\_\_\_\_  
at \_\_\_\_\_ o'clock \_\_\_\_\_ M.

.....  
(Register of Deeds)

By \_\_\_\_\_ Deputy