

CERTIFIED LAND CORNER RESTORATION

Index No. J-19

State of Wisconsin }  
County of Lanxlade } ss.

History of original corner establishment:

Corner set in the 1930 resurvey.

I Raymond J. Hallisy, do hereby certify that on the 29th day of April, 1978, I found evidence of the 1/4 corner of Section 11 & 14 Township 32, North, Range 12E, Fourth Principal Meridian, as described hereon; and that from this evidence I established a new monument and accessories as described hereon to perpetuate the original location of this corner.

Description of corner evidence found:

4" iron pipe with brass cap.

Resident witnesses:

Description of monument and accessories I established to perpetuate the original location of this corner.

New ET's

8" Spruce S17E 16' 10"  
5" Spruce S15W 13' 7"  
8" Spruce S76W 9' 6"

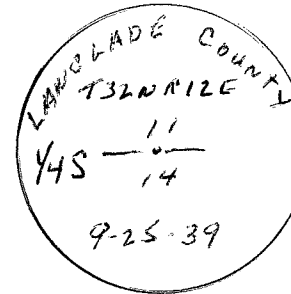

FORM 985 H. C. MILLER CO., MILWAUKEE

T32N R12E

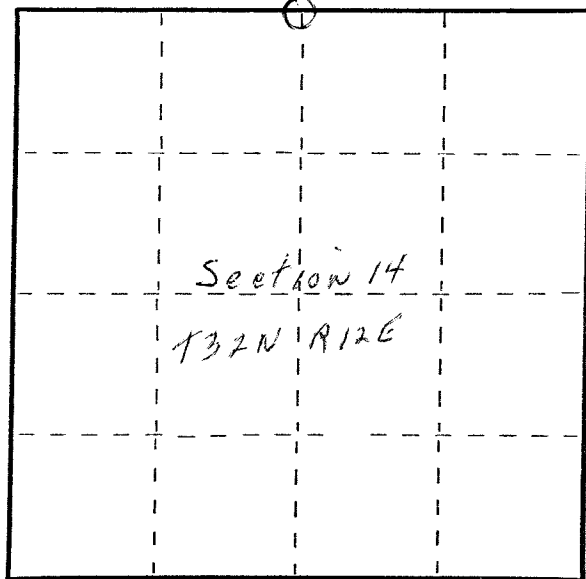

○ = Corner monument restored.

Dated at Antigo, Wis., this 29th day of April, 1978

Signature Raymond J. Hallisy Title Reg. Land Surveyor Registration No. S685  
(County Surveyor, Registered Land Surveyor, or other duly authorized official)

Office of Register of Deeds, County of \_\_\_\_\_, I hereby certify that the within instrument was filed in this office for record on the \_\_\_\_\_ day of \_\_\_\_\_, 19\_\_\_\_ at \_\_\_\_\_ o'clock \_\_\_\_\_ M.

(Register of Deeds)

By \_\_\_\_\_ Deputy