

CERTIFIED LAND CORNER RESTORATION

Index No. J-16

32-12

State of Wisconsin }  
County of LANGLADE } ss.

History of original corner establishment:

SET IN RESURVEY OF 1930,3

I RAYMOND J. HALLISY, do hereby certify that on the 19<sup>TH</sup> day of MAY, 19 73, I found evidence of the EAST 1/6 corner of SECTION 10 & 15 Township 32, North, Range 12 EAST, Fourth Principal Meridian, as described hereon; and that from this evidence I established a new monument and accessories as described hereon to perpetuate the original location of this corner.

Description of corner evidence found:

FOUND SQUARE STAKE, SCRIBED & DOWN POINT IN GROUND

Resident witnesses:

.....  
.....  
.....

Description of monument and accessories I established to perpetuate the original location of this corner.

1 1/2 INCH IRON PIPE WITH BRASS CAP

NEW B.T.s  
HARD MAPLE 6" S47W 4 FT. 11 INCHS  
HARD MAPLE 6" N49E 10 FT 7 INCHS

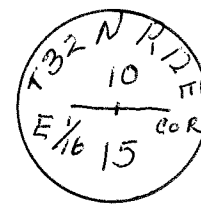

FORM 985 H. C. MILLER CO., MILWAUKEE

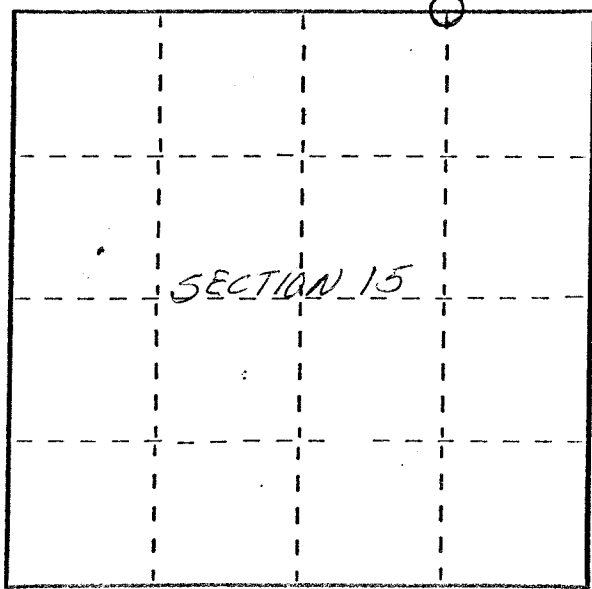

○ = Corner monument restored.

Dated at ANTIGO, Wis., this 19<sup>TH</sup> day of MAY, 19 73

Signature Raymond J. Hallisy Title Reg. Land Surveyor Registration No. 5-685  
(County Surveyor, Registered Land Surveyor, or other duly authorized official)

Office of Register of Deeds, County of....., I hereby certify that the within instrument was filed in this office for record on the..... day of....., 19..... at..... o'clock..... M.

(Register of Deeds)

By..... Deputy