

# U. S. PUBLIC LAND SURVEY MONUMENT RECORD

**I N S T R U C T I O N S:**

This record shall show the location of the corner and shall include all of the following nine elements (a through i).

- (a) Identify the corner by reference to the U.S. public land survey system.  
O = Corner monument restored.

Nortywest corner of Section 15,  
T32N, R12E

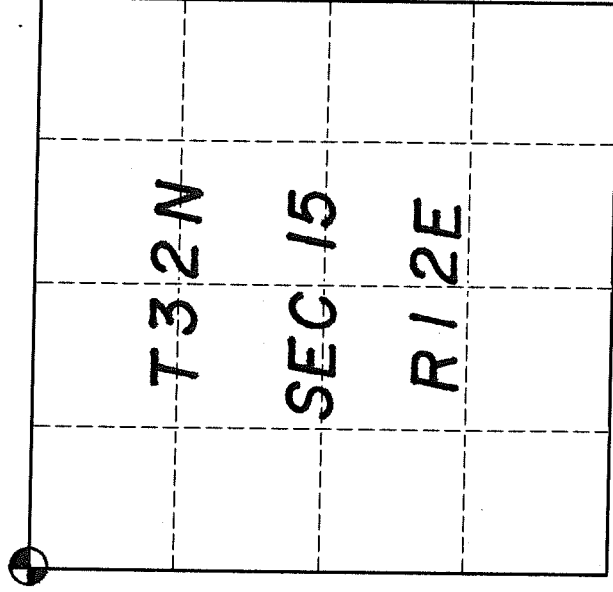

- (b) Describe any record evidence, monument evidence, occupational evidence, testimonial evidence or any other material evidence you considered, and whether the monument was found or placed.

1857 - James McBride, contract surveyor, set a wood post an marked bearing trees at this corner location.

1939 - D.A. Hintz, WPA Surveyor, found evidence of this corner location and monumented same with a 3" iron pipe and brass cap.

1996 - Kim Pritzlaff, RLS found Hintz's iron pipe in good condition just east of an old logging trail with two previously blazed Yellow Birch trees facing it. The pipe was accepted and new ties set as shown herein.

- (c) In the plan view drawing below, provide reference ties to at least 4 witness monuments, or, if the location is within a municipality, to at least 2 witness monuments. (Witness monuments shall be made of concrete, natural stone, iron or other equally durable material.)  
Describe witness monuments.

- (d) Show a plan view drawing depicting the relevant monuments and reference ties which is sufficient in detail to enable accurate relocation of the corner monument if the corner monument is disturbed. Indicate north.

The corner consists of a 3" iron pipe with brass cap stamped for corner in rock cairn. Tress shown were blazed and scribed "BT" at the root crown. Distances are to aluminum nails driven into the side of the trees. Bearing are magnetic. The sign post is a fiberglass "Tee" post white.

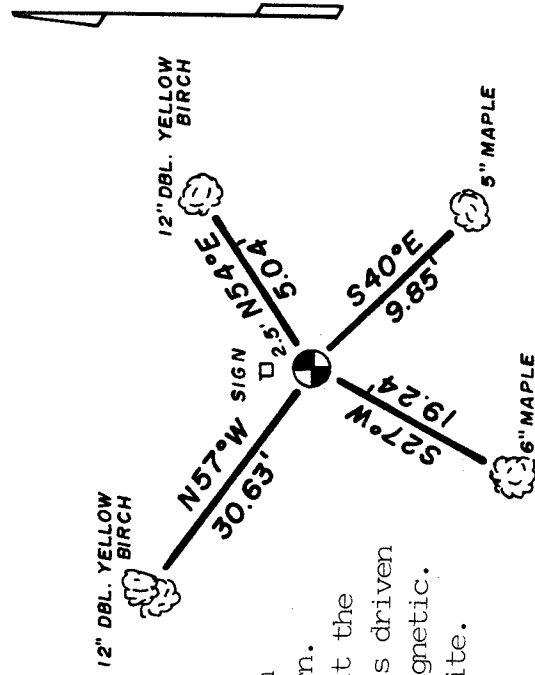

Describe any material discrepancy between the location of the corner as restored or reestablished and the location of that corner as previously restored or reestablished by distance and direction. Show the discrepancy on the plan view drawing under (d), above. Show the distances between the corner as previously restored or reestablished and (1) the corner as restored or reestablished, and (2) to at least 2 of the witness monuments shown on the drawing in (d), above.

None

(f) Was the corner restored through acceptance of (1) an obliterated evidence location, or, (2) a found perpetuated location.?

Found perpetuated location

(g & h) Was the corner reestablished through lost corner proportionate methods? If so, show the method, including the directions and distances to other public land survey corners used as evidence or used for proportioning in determining the corner location.

No

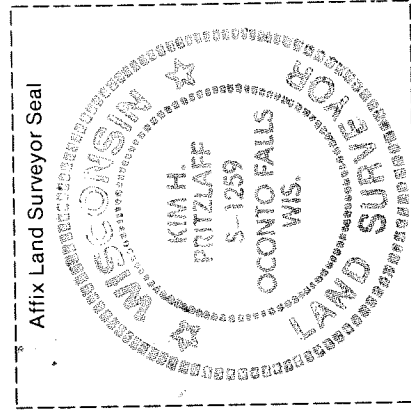

(i) I, Kim H Pritzlaff, RLS No. 1259  
(type or print name)

certify that the corner location shown on this record was determined by me or under my direction and control and that this U.S. Public Land Survey Monument Record is correct and complete to the best of my knowledge and belief.

Signature

10/96

Date