

CERTIFIED LAND CORNER RESTORATION

32-12

Index No. F-9

State of Wisconsin }
County of Langlade } ss.

I, Raymond J. Hallisy, do hereby certify that on the 22nd day of June, 19 68, I found evidence of the N 1/16 corner of Section 8 Township 33 32, North, Range 12, Fourth, Principal Meridian, as described hereon; and that from this evidence I established a new monument and accessories as described hereon to perpetuate the original location of this corner.

History of original corner establishment:

Corner set in the 1930's by: E. F. Kowalke
C. W. Borth

Description of corner evidence found:

Found squared stake standing, marked N 1/16 S8 S9

Resident witnesses:

.....
.....
.....

Description of monument and accessories I established to perpetuate the original location of this corner.
Set std. 1 1/2" pipe with cap marked N 1/16 S8 S9

FORM 985 H. C. MILLER CO., MILWAUKEE

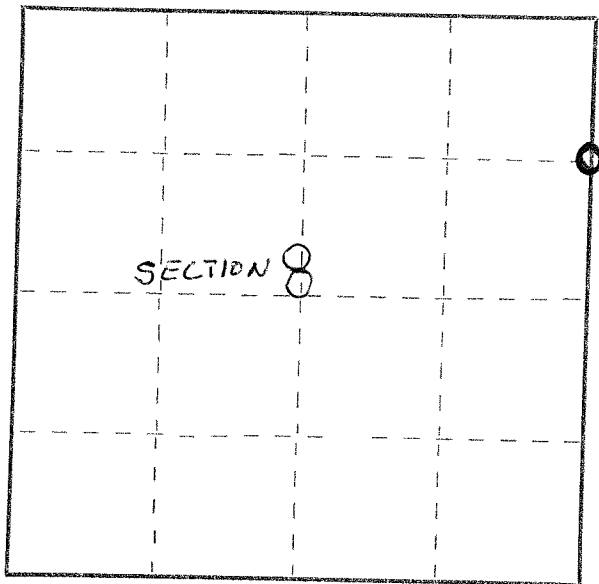

○ = Corner monument restored.

20" ELM stump N72W 37'3" → ○
SCRIBED BT

6" ASPEN S54W 1'9" → ○
SCRIBED BT

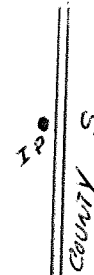

Dated at Antigo, Wis., this 22nd day of June, 19 68.

Signature Raymond Hallisy Title Land Surveyor Registration No. S-685
(County Surveyor, Registered Land Surveyor, or other duly authorized official)

Office of Register of Deeds, County of Langlade, I hereby certify that the within instrument was filed in this office for record on the _____ day of _____, 19____ at _____ o'clock _____ M.

.....
(Register of Deeds)

By _____ Deputy