

CERTIFIED LAND CORNER RESTORATION

32-12

Index No. J-6

State of Wisconsin }
 County of LANGLADE } ss.

History of original corner establishment:

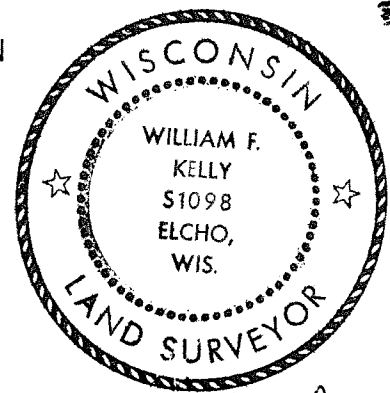

William F. Kelly 11 July 1924

I, Wm. F. Kelly, do hereby certify that on the 11th day of July, 1974, I found evidence of the W 1/8 Sec. corner of SECS. 8 & 17 Township 32 12 EAST, North, Range 12 EAST, Fourth Principal Meridian, as described hereon; and that from this evidence I established a new monument and accessories as described hereon to perpetuate the original location of this corner.

Description of corner evidence found:

ORIGINAL WOOD POST ON GROUND BESIDE 1/2" GALV. PIPE FOUND 2 ORIGINAL B.T.'S SCRIBED B.T. 1 ADD. W/GALV. CAP

Resident witnesses:

.....

Description of monument and accessories I established to perpetuate the original location of this corner.

IRON POST IN GOOD COND. SOLID. REBLAZED BLAZED AND BLAZED ONE ADD. TREE.

3 ORIG. B.T. MKD. BT AT BASE
MAPLE 10 N 28 W 25.3'

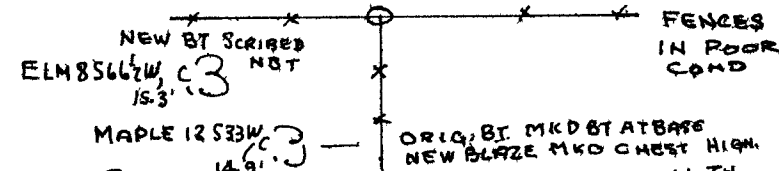
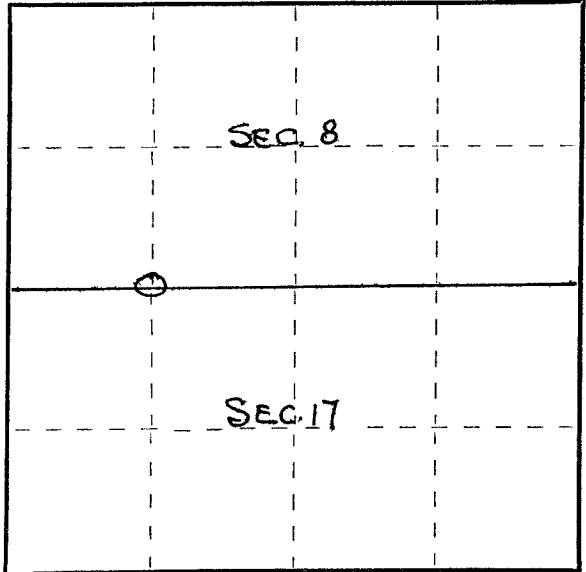
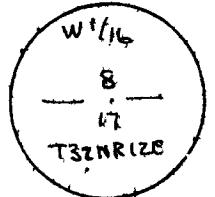

Dated at ELCHO, Wis., this 11th day of JULY, 1974

Signature William F. Kelly Title REG. LAND SURVEYOR Registration No. 5-1098
 (County Surveyor, Registered Land Surveyor, or other duly authorized official)

Office of Register of Deeds, County of, I hereby certify that the within instrument was filed in this office for record on the day of, 19..... at o'clock M.

(Register of Deeds)

By Deputy

○ = Corner monument restored.

FORM 985 H. C. MILLER CO., MILWAUKEE