

CERTIFIED LAND CORNER RESTORATION

32-12

Index No. J-7

State of Wisconsin }  
County of LANGLADE } ss.

History of original corner establishment:  
SET BY KOWALKE - CIRCA 1939.

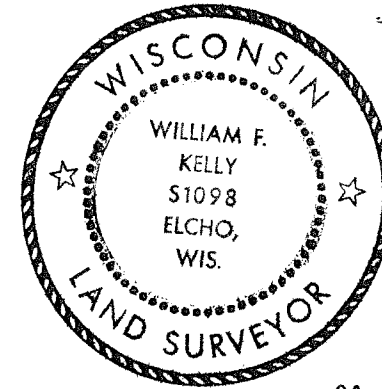

William F. Kelly 11 July 1974

I, W. M. F. KELLY, do hereby certify that on the 11<sup>TH</sup> day of JULY, 1974, I found evidence of the 1/4 SECTION corner of SECS. 8 & 17 Township 32, North, Range 12 EAST, Fourth Principal Meridian, as described hereon; and that from this evidence I established a new monument and accessories as described hereon to perpetuate the original location of this corner.

Description of corner evidence found:  
FOUND 4" PIPE w/ BRASS CAP - FOLLOWING HUTCHINSON'S NOTES.

Resident witnesses:

Description of monument and accessories I established to perpetuate the original location of this corner.

SET MOUND OF STONES AROUND MON &  
BLAZED 3 TREES.

- 1= MAPLE 8 N 38 1/2 W 30.1
- 2= BASSWOOD 6 N 88 1/2 E 16.95
- 3= BLACK CHERRY 8 S 13 E 13.35

ALL TREES BLAZED & SCRIBED NBT.

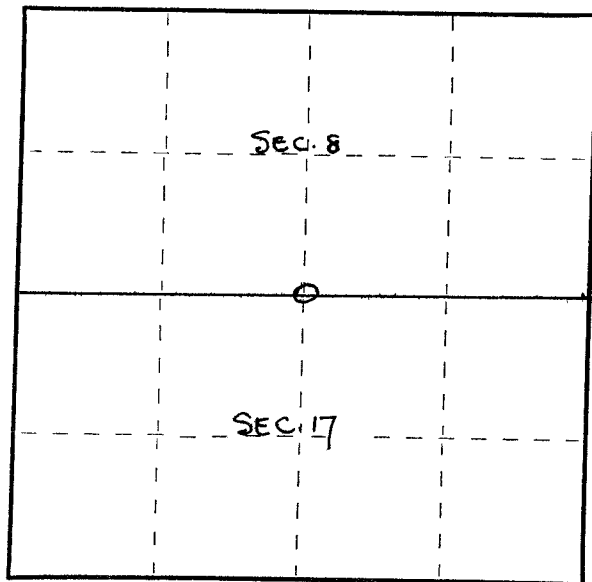

○ = Corner monument restored.

Dated at ELCHO, Wis., this 11<sup>TH</sup> day of JULY, 1974.

Signature William F. Kelly Title REG. LAND SURVEYOR Registration No. S-1098  
(County Surveyor, Registered Land Surveyor, or other duly authorized official)

Office of Register of Deeds, County of \_\_\_\_\_, I hereby certify that the within instrument was filed in this office for record on the \_\_\_\_\_ day of \_\_\_\_\_, 19\_\_\_\_ at \_\_\_\_\_ o'clock \_\_\_\_\_ M.

(Register of Deeds)

By \_\_\_\_\_ Deputy

FORM 985 R. C. MILLER CO., MILWAUKEE