

CERTIFIED LAND CORNER RESTORATION

3242
Index No. F-5

State of Wisconsin }
County of Lanlade } ss.

History of original corner establishment:

I, Raymond J. Hallisy do hereby certify that on the 22nd day of June, 1968, I found evidence of the N 1/16 corner of Section 7 Township 32, North, Range 12, Fourth, Principal Meridian, as described hereon; and that from this evidence I established a new monument and accessories as described hereon to perpetuate the original location of this corner.

Corner set in the 1930's by: E. F. Kowalke
C. W. Borth

Description of corner evidence found:

Found squared stake down point intact
Marked WC Cor. 50 LKS W N 1/16

Resident witnesses:

.....
.....
.....

Description of monument and accessories I established to perpetuate the original location of this corner.
Set $1\frac{1}{2}$ " pipe with 4" brass cap marked

FORM 985 P. V. MILLER CO., MILWAUKEE

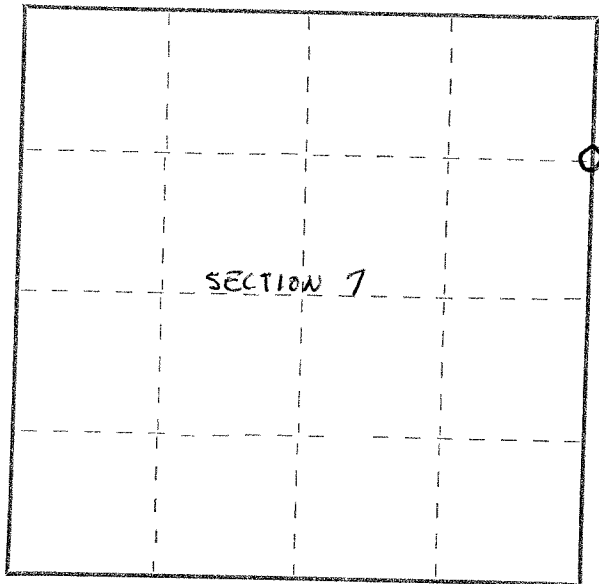

○ = Corner monument restored.

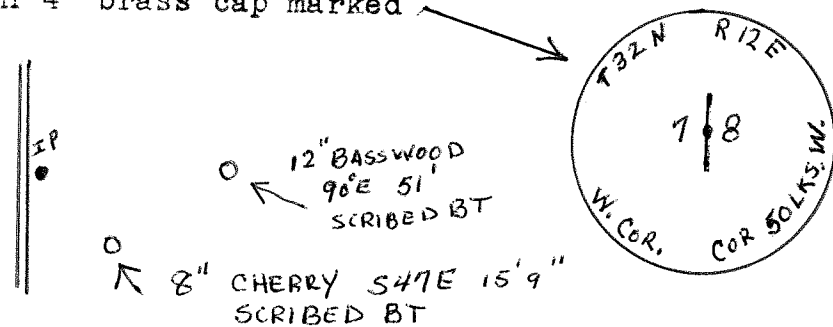

Dated at Antigo, Wis., this 22nd day of June, 1968

Signature: Raymond J. Hallisy Title: Land Surveyor Registration No. S-685
(County Surveyor, Registered Land Surveyor, or other duly authorized official)

Office of Register of Deeds, County of _____, I hereby certify that the within instrument was filed in this office for record on the _____ day of _____, 19____ at _____ o'clock _____ M.

(Register of Deeds)

By _____ Deputy