

CERTIFIED LAND CORNER RESTORATION

32-12

Index No. J-2

State of Wisconsin }
County of Langlade } ss.

I, Raymond J. Hallisy, do hereby certify that on the 25th day of April, 1970, I found evidence of the W 1/16 corner of Section 7 Township 32, North, Range 12E, Fourth, Principal Meridian, as described hereon; and that from this evidence I established a new monument and accessories as described hereon to perpetuate the original location of this corner.

History of original corner establishment:

Corner set in the 1930 resurvey.

Description of corner evidence found:

Found old stake standing also 3/4" pipe & 1" pipe along side. Stake marked W 1/16 S7 S18

Resident witnesses:

J. Weir
J. Kryka

Description of monument and accessories I established to perpetuate the original location of this corner.

Set 2" pipe with brass cap, rock mound.
New B.T.'s
Hard Maple 10" N8E 26.4 Ft.
Hard Maple 6" N76W 17.3 Ft.
B.T.'s faced at base of tree and scribed BT.



FORM 985 H. C. MILLER CO., MILWAUKEE

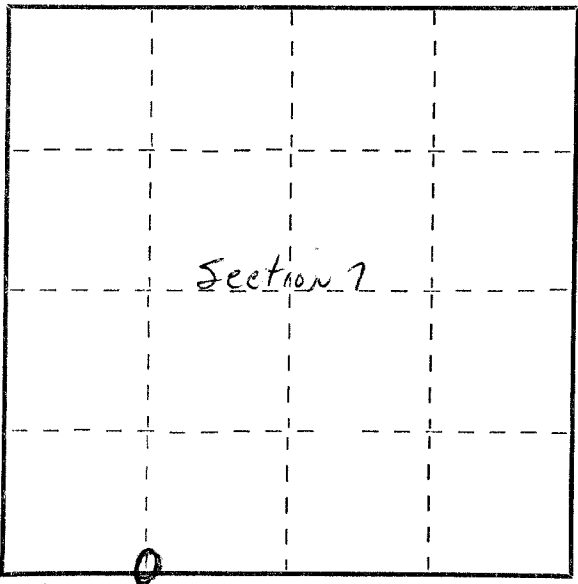

○ = Corner monument restored.

Dated at Antigo, Wis., this 25th day of April, 1970

Signature Raymond J. Hallisy Title Reg. Land Surveyor Registration No. S-685
(County Surveyor, Registered Land Surveyor, or other duly authorized official)

Office of Register of Deeds, County of _____, I hereby certify that the within instrument was filed in this office for record on the _____ day of _____, 19____ at _____ o'clock _____ M.

(Register of Deeds)
By _____ Deputy