

CERTIFIED LAND CORNER RESTORATION

32-17
Index No. E-4

State of Wisconsin }
County of Langlade } ss.

I, Raymond J. Hallisy, do hereby certify that on the 25th day of April, 19 70, I found evidence of the E 1/16 corner of Section 7 Township 32, North, Range 12E, Fourth, Principal Meridian, as described hereon; and that from this evidence I established a new monument and accessories as described hereon to perpetuate the original location of this corner.

Resident witnesses:

J. Weir
J. Krupke

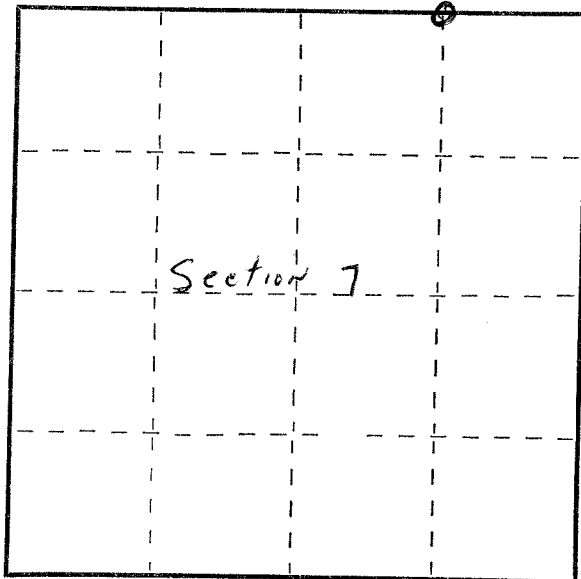

○ = Corner monument restored.

History of original corner establishment:

Corner set in the 1930 resurvey.

Description of corner evidence found:

Found old stake down, marked S7 S6 E1/16

Description of monument and accessories I established to perpetuate the original location of this corner.

Set 2" pipe with brass cap, rock mound.

New B.T.'s

Hard Maple 16" 90E 1Ft. 8 inches

Elm 8" S9W 5Ft. 11 inches

B.T.'s faced at base of trees and scribed BT.



Dated at Antigo, Wis., this 25th day of April, 19 70

Signature Raymond J. Hallisy Title Reg. Land Surveyor Registration No. S-685
(County Surveyor, Registered Land Surveyor, or other duly authorized official)

Office of Register of Deeds, County of _____, I hereby certify that the within instrument was filed in this office for record on the _____ day of _____, 19 _____ at _____ o'clock _____ M.

(Register of Deeds)

By _____ Deputy