

CERTIFIED LAND CORNER RESTORATION

32-12  
Index No. B-13

State of Wisconsin }  
County of Langlade } ss.

I Raymond J. Hallisy do hereby  
certify that on the 13th day  
of June, 1971, I found  
evidence of the N 1/16  
corner of Section 4 & 3  
Township 32, North, Range  
12E, Fourth, Principal Meridian,  
as described hereon; and that from this evidence  
I established a new monument and accessories  
as described hereon to perpetuate the original  
location of this corner.

Resident witnesses:

.....  
.....  
.....

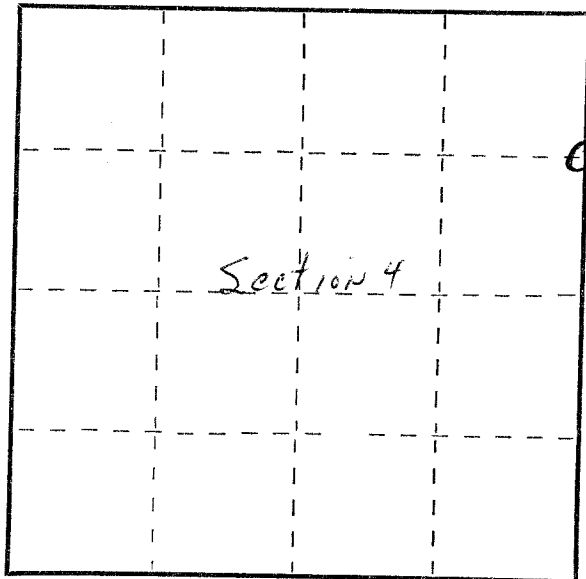

○ = Corner monument restored.

History of original corner establishment:

Corner set in the 1930 resurvey.

Description of corner evidence found:

Found old wood stake down, point intact, rock mound  
Marked N1/16 S4 S3

Description of monument and accessories I established to perpetuate the original location of this corner.

Set 2" pipe with brass cap, rock mound.

BT's to corner  
5" Hard Maple N70W 13Feet 7 inches  
10" Elm S54E 5 Feet 4 inches  
BT's faced at base of tree and scribed BT.

X32N R12E  
Sec 4 | see  
4 | 3  
N 1/16

Dated at Antigo, Wis., this 13th day of June, 1971

Signature: R. J. Hallisy Title: Reg. Land Surveyor Registration No. 5685  
(County Surveyor, Registered Land Surveyor, or other duly authorized official)

Office of Register of Deeds, County of \_\_\_\_\_, I hereby certify that the within  
instrument was filed in this office for record on the \_\_\_\_\_ day of \_\_\_\_\_, 19\_\_\_\_  
at \_\_\_\_\_ o'clock \_\_\_\_\_ M.

(Register of Deeds)

By \_\_\_\_\_ Deputy