

CERTIFIED LAND CORNER RESTORATION

32-12
Index No. B-21

State of Wisconsin }
County of Langlade } ss.

History of original corner establishment:

Corner set in the 1930 resurvey

I Raymond J. Hallisy, do hereby certify that on the 14th day of June, 19 69, I found evidence of the N 1/16 corner of Section 1 Township 32, North, Range 12E, Fourth Principal Meridian, as described hereon; and that from this evidence I established a new monument and accessories as described hereon to perpetuate the original location of this corner.

Description of corner evidence found:

Found squared post in place, marked N 1/16 S 1 S 2 also rock mound

Resident witnesses:

.....
.....
.....

Description of monument and accessories I established to perpetuate the original location of this corner.

Reset 2" pipe with brass cap, rock mound
B.T.'s to corner
Hard Maple 10" S23E 14 Ft. 9 inches
Elm 12" N8W 3 Ft. 9 inches
B.T.'s faced at base and scribed BT

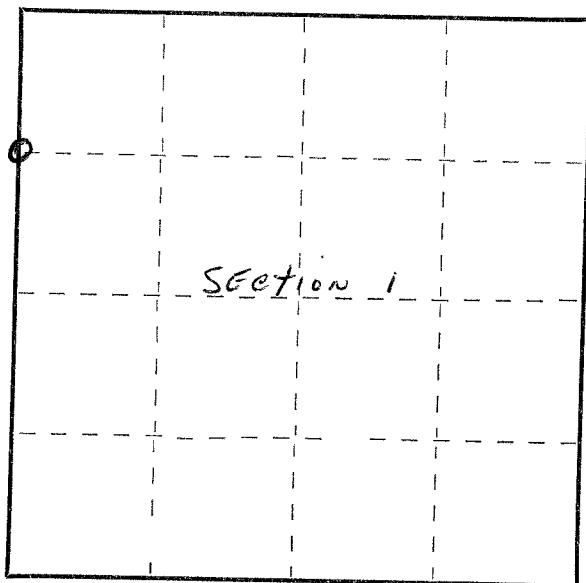
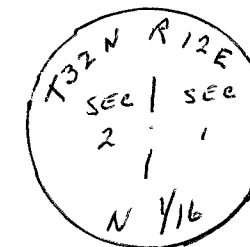

○ = Corner monument restored.

Dated at Antigo, Wis., this 14th day of June, 19 69

Signature Raymond J. Hallisy Title Reg. Land Surveyor Registration No. S-685
(County Surveyor, Registered Land Surveyor, or other duly authorized official)

Office of Register of Deeds, County of _____, I hereby certify that the within instrument was filed in this office for record on the _____ day of _____, 19 _____ at _____ o'clock _____ M.

.....
(Register of Deeds)

By _____ Deputy

FORM 985 H. C. MILLER CO., MILWAUKEE