

CERTIFIED LAND CORNER RESTORATION

Index No. T-13

State of Wisconsin }  
County of Langlade } ss.

History of original corner establishment:  
Resurvey Notes

I Gary A. Radtke, do hereby certify that on the 21 day of June 1978, I found evidence of the East 1/4 Corner corner of Section 28 Township 32 North, Range 11 East, Fourth Principal Meridian, as described hereon; and that from this evidence I established a new monument and accessories as described hereon to perpetuate the original location of this corner.

Description of corner evidence found:  
Old Fence Lines

Resident witnesses:



Description of monument and accessories I established to perpetuate the original location of this corner.

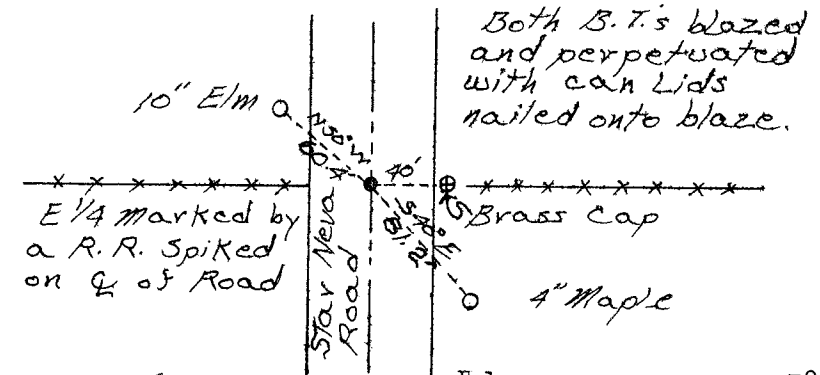
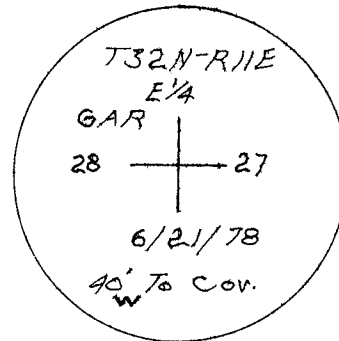
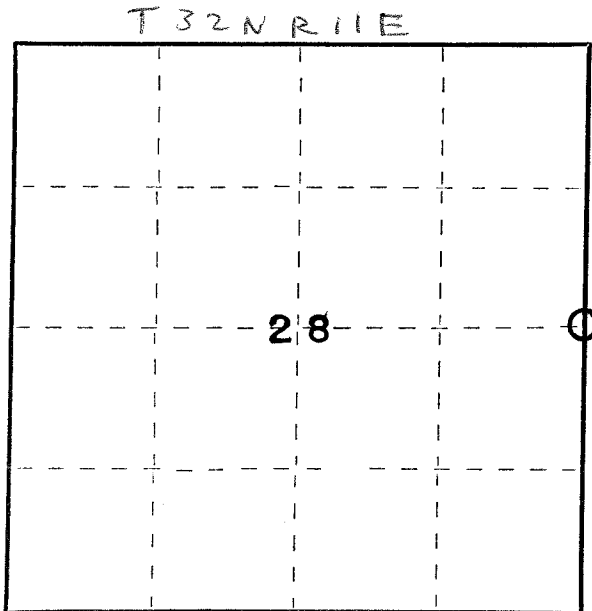

Dated at Antigo, Wis., this 6th day of July, 1978

Signature: [Signature] Title: Registered Land Surveyor Registration No. S-1248  
(County Surveyor, Registered Land Surveyor, or other duly authorized official)

Office of Register of Deeds, County of \_\_\_\_\_, I hereby certify that the within instrument was filed in this office for record on the \_\_\_\_\_ day of \_\_\_\_\_, 19\_\_\_\_ at \_\_\_\_\_ o'clock \_\_\_\_\_ M.

(Register of Deeds)

By \_\_\_\_\_ Deputy

○ = Corner monument restored.

FORM 965 H. C. MILLER CO., MILWAUKEE