

43211182000

# U.S. PUBLIC LAND SURVEY MONUMENT RECORD

NOTE: This form is intended and designed to fulfill all requirements of Wisconsin Administrative Code, Chapter A-E 7.08 U.S. Public Land Survey Monument Record (3)(a)(b)(c)(d)(e)(f)(g)(h)(i). An additional sheet may be added if necessary to conform with said requirements.

(a) Corner location: Township 32 North  
Range 11 East

Town of NEVA, LANGLADE County, Wisconsin

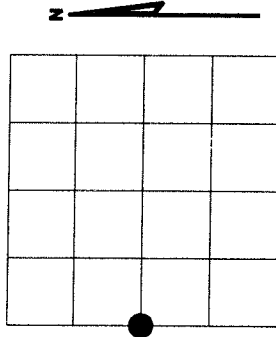

Section 17

## THIS CORNER WAS RESTORED THROUGH ACCEPTANCE OF A FOUND PERPETUATED LOCATION AND SINGLE PROPORTIONATE METHOD.

(b)(f)(g)(h) Description of monument found at this corner and if it was accepted, state all evidence (material, testimonial, occupational, plats, records, other monuments) used as a basis for accepting. If not accepted or if nothing was found, state evidence used as basis for establishing location. If reestablished through lost corner proportionate methods, indicate all monuments, distances and directions used to establish. Indicate type of monument found or set and sign post.

**The original corner was established in 1860 by H.C. Fellows. William Kelly referenced to this corner being midpoint between section corners on plat of survey dated 1-31-1889. Could find no other reference to this corner. At site found old fence line running North and South. Took measurements to existing evidence. I established this corner at equal distance between the Northwest and Southwest corners of Section 17 and set on fence line running North-South. Believe old fence best perpetuated original corner location in East-West direction.**

(c)(d)(e) Plan view of corner with ties to at least 4 witness monuments. If in disagreement with previously established corner, show the distances between the two corners and also indicate the ties to the disputed corner.

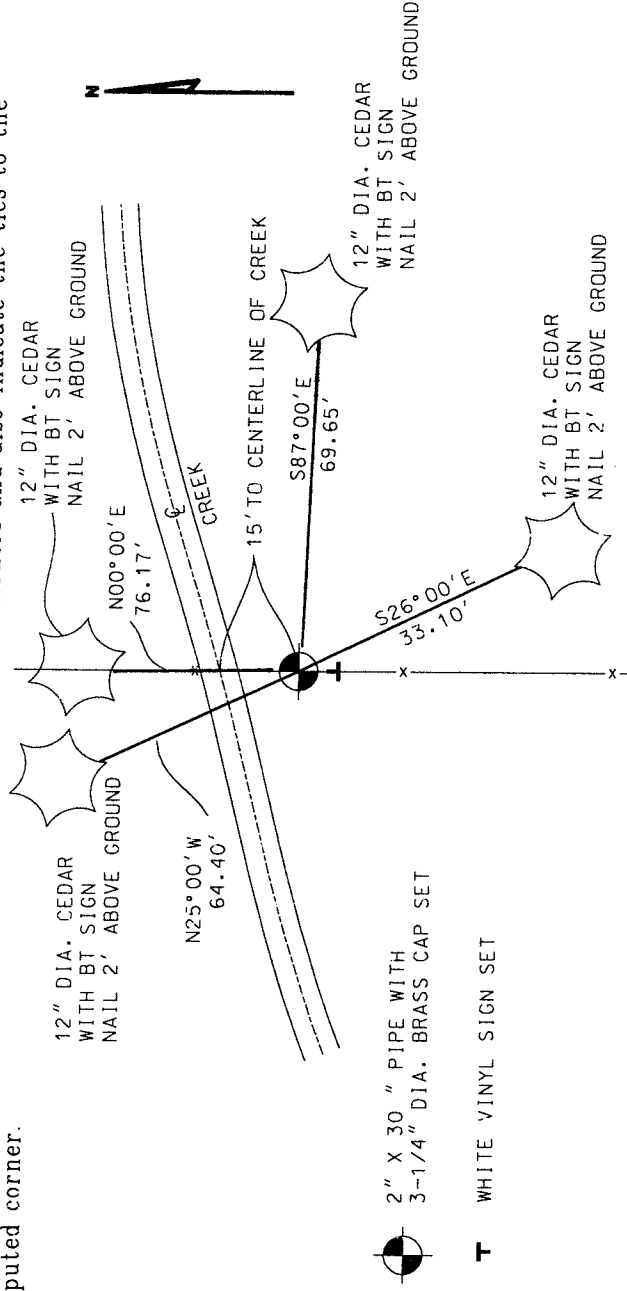

(i) I, Eugene C. Uttech, Registered Land Surveyor \*S-1451 hereby certify that the corner location on this record was determined by me or under my direction and control and that this U.S. Public Land Survey Monument Record is correct and complete to the best of my knowledge and belief.

*Eugene C. Uttech*  
Signature

*8/22/02*  
Date

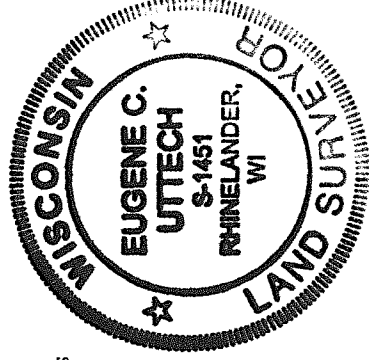

Index No. 25