

CERTIFIED LAND CORNER RESTORATION

Index No. M-16

State of Wisconsin }
 County of LANGLADE } ss.

I WILLIAM F. KELLY, do hereby certify that on the 3rd day of APRIL, 1979, I found evidence of the SE 1/4 corner of SEC. 15 Township 32, North, Range 11E, Fourth Principal Meridian, as described hereon; and that from this evidence I established a new monument and accessories as described hereon to perpetuate the original location of this corner.

Resident witnesses:

.....

History of original corner establishment:

Description of corner evidence found:
FOUND IRON WELL POINT AT INTERSECTION OF FENCE LINES. REPLACED WITH 1 1/2" x 42" IRON PIPE WITH BRASS CAP REFERENCED TO 3 BEARING TREES

Description of monument and accessories I established to perpetuate the original location of this corner.

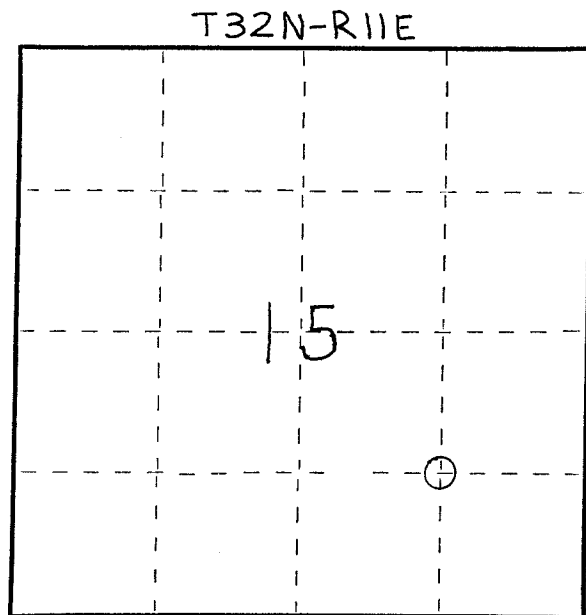

○ = Corner monument restored.

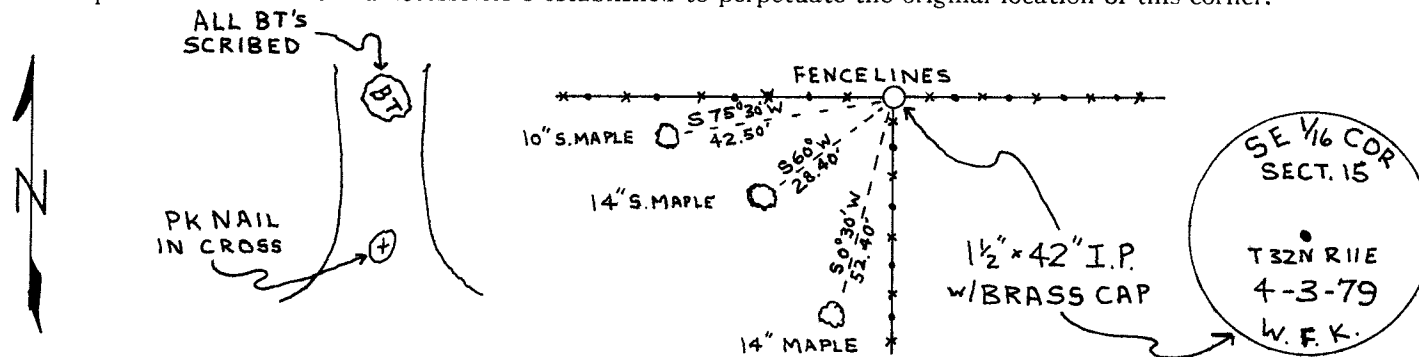

Dated at ELCHO, Wis., this 3rd day of APRIL, 1979.

Signature..... Title COUNTY SURVEYOR Registration No. S-1098
 (County Surveyor, Registered Land Surveyor, or other duly authorized official)

Office of Register of Deeds, County of....., I hereby certify that the within instrument was filed in this office for record on the..... day of....., 19..... at..... o'clock..... M.

.....
 (Register of Deeds)

By..... Deputy

FORM 985 H. C. MILLER CO., MILWAUKEE