

CERTIFIED LAND CORNER RESTORATION

32-12  
Index No. F-1

State of Wisconsin }  
County of Langlade } ss.

History of original corner establishment:

I Raymond J. Hallisy, do hereby  
certify that on the 22nd day  
of June, 1968, I found  
evidence of the N 1/16  
corner of Section 7  
Township 32, North, Range  
12, Fourth, Principal Meridian,  
as described hereon; and that from this evidence  
I established a new monument and accessories  
as described hereon to perpetuate the original  
location of this corner.

Corner set in the 1930's by: E. F. Kowalke  
C. W. Borth

Description of corner evidence found:

**Found squared stake standing in good shape**  
**Marked N 1/16 S12 S7**

Resident witnesses:

Description of monument and accessories I established to perpetuate the original location of this corner.

Set std. 1 1/2" pipe with cap marked N1/16 12 7

FORM 985 H. C. MILLER CO., MILWAUKEE

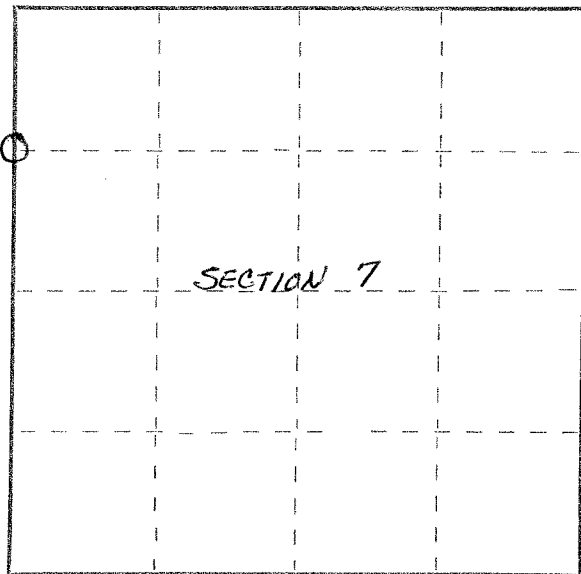

6" ASPEN N32W 9' 4" SCRIBED BT → ○ IP ○ ← 6" ASPEN N88E 30' 2" SCRIBED BT

Dated at Antigo, Wis., this 22nd day of June, 1968.

Signature: Raymond J. Hallisy Title: Land Surveyor Registration No. S-685  
(County Surveyor, Registered Land Surveyor, or other duly authorized official)

Office of Register of Deeds, County of \_\_\_\_\_, I hereby certify that the within  
instrument was filed in this office for record on the \_\_\_\_\_ day of \_\_\_\_\_, 19\_\_\_\_  
at \_\_\_\_\_ o'clock \_\_\_\_\_ M.

(Register of Deeds)

By \_\_\_\_\_ Deputy

○ = Corner monument restored.