

CERTIFIED LAND CORNER RESTORATION

32-12 H-1  
Index No. [REDACTED]

State of Wisconsin }  
County of LADYSLADE } ss.

History of original corner establishment:

CORNER Set in The 1930 RESURVEY

I, Raymond J. Harris, do hereby certify that on the 11<sup>th</sup> day of July, 1971, I found evidence of the S 1/16 corner of Section 7 + 12 Township 32, North, Range 11 + 12 E, Fourth, Principal Meridian, as described hereon; and that from this evidence I established a new monument and accessories as described hereon to perpetuate the original location of this corner.

Description of corner evidence found:

Found wood post down, point intact, MARKED S 1/16 S7 S12

Resident witnesses:

.....  
.....  
.....

Description of monument and accessories I established to perpetuate the original location of this corner.

Set 2" pipe with BRASS CAP.

BT'S TO CORNER

Aspen 11" N 24 E 6 FT 2 IN.

Cherry 8" N 78 W 2 FT 1 IN.

BT'S FACED AT BASE OF TREE AND SCRIBED BT

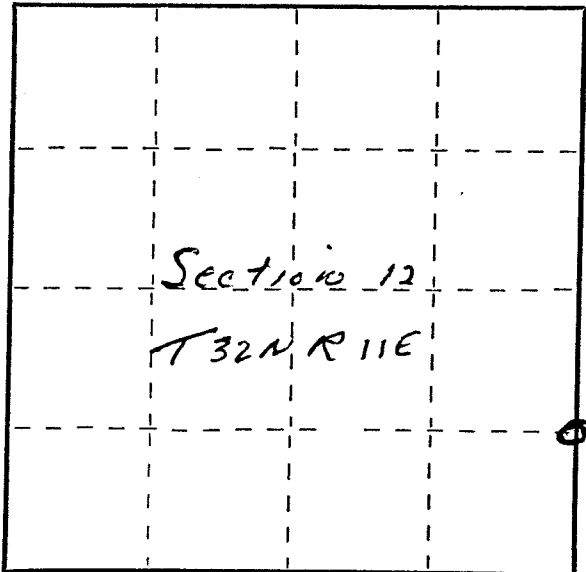
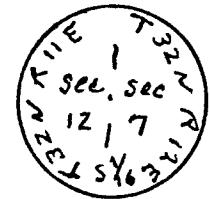

○ = Corner monument restored.

Dated at Antigo, Wis., this 11<sup>th</sup> day of July, 1971.

Signature Raymond J. Harris title Reg Land Surveyor Registration No. 5-685  
(County Surveyor, Registered Land Surveyor, or other duly authorized official)

Office of Register of Deeds, County of \_\_\_\_\_, I hereby certify that the within instrument was filed in this office for record on the \_\_\_\_\_ day of \_\_\_\_\_, 19\_\_\_\_ at \_\_\_\_\_ o'clock \_\_\_\_\_ M.

.....  
(Register of Deeds)

By \_\_\_\_\_ Deputy