

CERTIFIED LAND CORNER RESTORATION

32-11

Index No. G-13

State of Wisconsin }
County of Lanlade } ss.

History of original corner establishment:

I Raymond J. Hallisy, do hereby certify that on the 22nd day of June, 1968, I found evidence of the 1/4 corner of Section 9 & 10 Township 32, North, Range 11, Fourth, Principal Meridian, as described hereon; and that from this evidence I established a new monument and accessories as described hereon to perpetuate the original location of this corner.

Description of corner evidence found:

Found old railroad tie as fence corner, tie was sc~~r~~abed 1/4 S WCD location poster next to road was down. Old fence to east and south, blazed line to west.

Resident witnesses:

Description of monument and accessories I established to perpetuate the original location of this corner.

Set 4" concrete 4' long with brass cap marked -

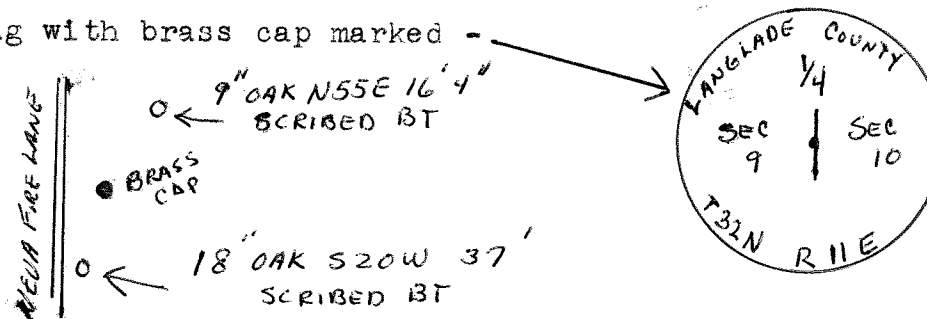
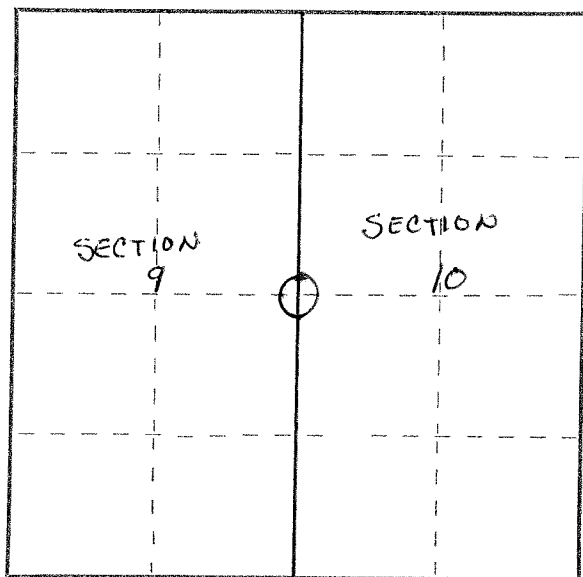

Dated at Antigo, Wis., this 22nd day of June, 1968.

Signature Raymond J. Hallisy Title Land Surveyor Registration No. 5685
(County Surveyor, Registered Land Surveyor, or other duly authorized official)

Office of Register of Deeds, County of _____, I hereby certify that the within instrument was filed in this office for record on the _____ day of _____, 19____ at _____ o'clock _____ M.

(Register of Deeds)

By _____ Deputy

○ = Corner monument restored.