

CERTIFIED LAND CORNER RESTORATION

Index No. J-10

State of Wisconsin }
County of LANGLADE } ss.

History of original corner establishment:

ORIGINAL CORNER ESTABLISHED BY HIRAM FELLOWS IN THE 1860'S.

I WILLIAM F. KELLY, do hereby certify that on the 17th day of JUNE, 1980, I found evidence of the W 1/8 corner of SECTION 9 Township 32, North, Range 11 EAST, Fourth Principal Meridian, as described hereon; and that from this evidence I established a new monument and accessories as described hereon to perpetuate the original location of this corner.

Description of corner evidence found:

NONE.

SET 1 1/2" x 42" IRON PIPE WITH BRASS CAP AT MIDDPOINT THE S 1/4 CORNER AND THE SW CORNER OF SECTION 9.

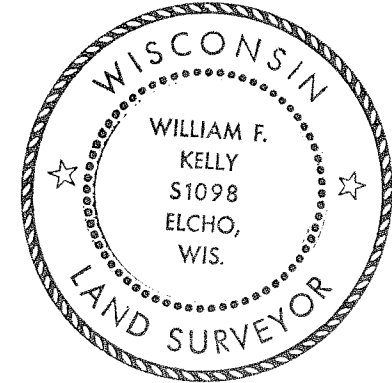

William F. Kelly

Resident witnesses:

Description of monument and accessories I established to perpetuate the original location of this corner.

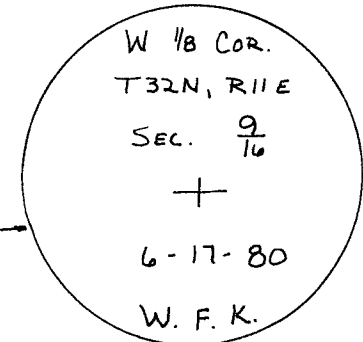
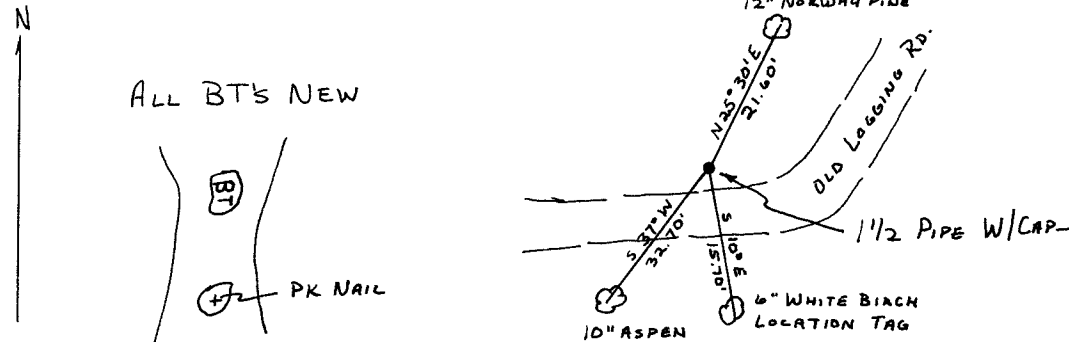
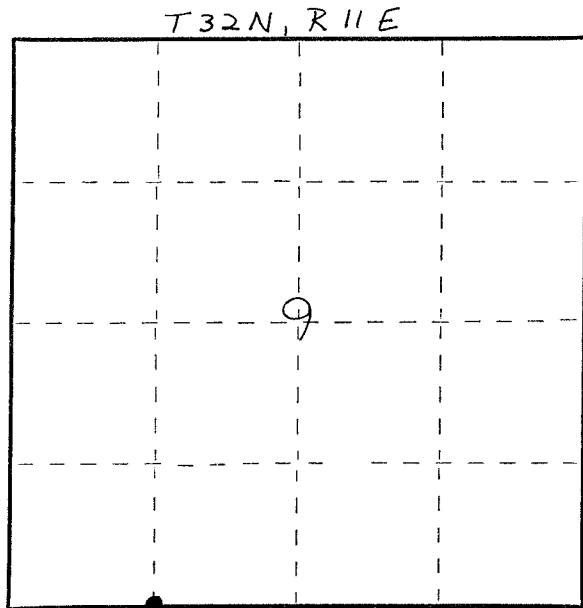

Dated at ELCHO, Wis., this 18th day of JUNE, 1980.

Signature William F. Kelly Title COUNTY SURVEYOR Registration No. S-1098
(County Surveyor, Registered Land Surveyor, or other duly authorized official)

Office of Register of Deeds, County of....., I hereby certify that the within instrument was filed in this office for record on the..... day of....., 19..... at..... o'clock..... M.

(Register of Deeds)

By..... Deputy

○ = Corner monument restored.