

CERTIFIED LAND CORNER RESTORATION

Index No. C-9

State of Wisconsin }
County of LANGLADE } ss.

History of original corner establishment:

ORIGINAL CORNER ESTABLISHED BY HIRAM FELLOWS IN THE 1860'S.

I WILLIAM F. KELLY, do hereby certify that on the 17th day of JUNE, 1980, I found evidence of the W 1/4 corner of SEC. 4 Township 32, North, Range 11 EAST, Fourth Principal Meridian, as described hereon; and that from this evidence I established a new monument and accessories as described hereon to perpetuate the original location of this corner.

Resident witnesses:

Description of corner evidence found:

NONE.

CORNER ESTABLISHED BY DOUBLE PROPORTIONMENT BETWEEN THE NW AND SW CORNERS OF SEC. 4.

SET A 2" x 42" IRON PIPE WITH BRASS CAP. THE 1/4 CORNER IS 6" OUT OF THE GROUND.

VOID (SEE NEW) D.T.

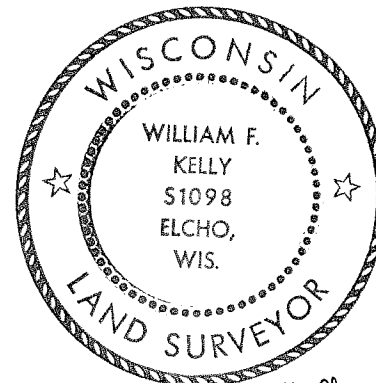

William F. Kelly

Description of monument and accessories I established to perpetuate the original location of this corner.

NOTE: CORNER FALLS IN AN OPEN FIELD APPROX. 75' SOUTH OF EXISTING ROADWAY. NO WITNESS TREES AVAILABLE. THE EXISTING FENCE LINE IS NORTH OF THE ROAD. THE CENTER OF THE ROADWAY HAS BEEN ASSUMED TO BE THE LINE AND PROPERTIES HAVE BEEN OCLUPIED AND USED BASED ON THE ASSUMED CORNER LOCATION.

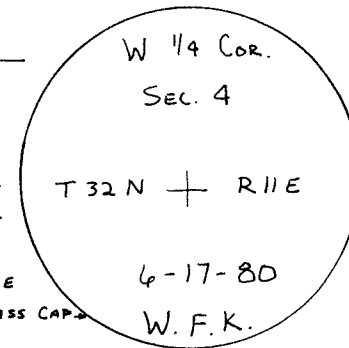
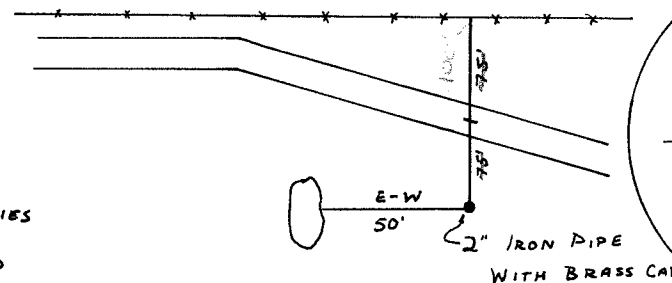

FORM 985 H. C. MILLER CO., MILWAUKEE

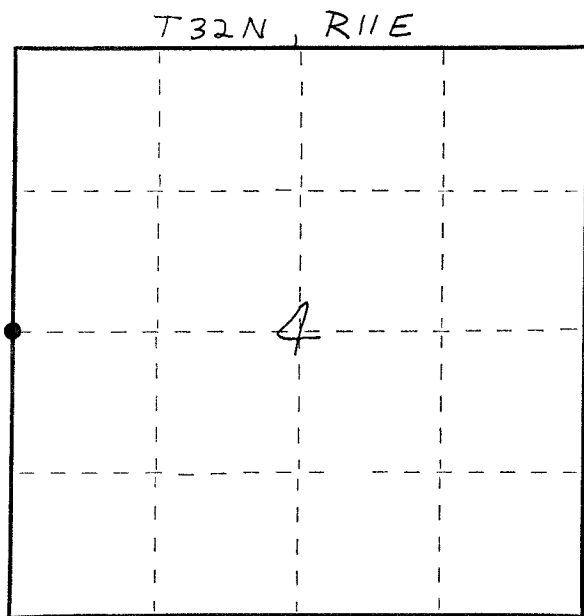

○ = Corner monument restored.

Dated at ELCHO, Wis., this 18th day of JUNE, 1980.

Signature William F. Kelly Title COUNTY SURVEYOR Registration No. S-1098
(County Surveyor, Registered Land Surveyor, or other duly authorized official)

Office of Register of Deeds, County of _____, I hereby certify that the within instrument was filed in this office for record on the _____ day of _____, 19____ at _____ o'clock _____ M.

(Register of Deeds)

By _____ Deputy