

CERTIFIED LAND CORNER RESTORATION

32-10

Index No. 225

State of Wisconsin }
County of LANGLADE } ss.

I ROBERT J. POSS, do hereby certify that on the 5TH day of JULY, 1969, I found evidence of the TOWN - RANGE corner of SEC. 1, 6, 31, 36 Township 31 & 32, North, Range 10 & 11 EAST, Fourth, Principal Meridian, as described hereon; and that from this evidence I established a new monument and accessories as described hereon to perpetuate the original location of this corner.

Resident witnesses:

JOHN MATUSZEWSKI

History of original corner establishment:

Description of corner evidence found:

IRON PIPE - IN ABOUT 3 FT. FILL. PICKED LOCATION WITH DIP NEEDLE. MATUSZEWSKI CONFIRMED LOCATION.

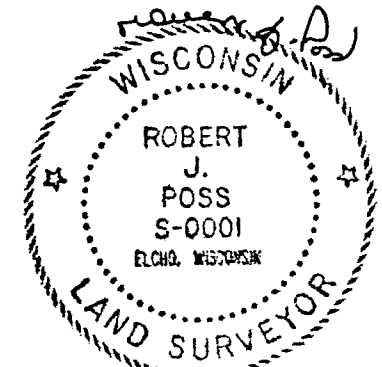

Description of monument and accessories I established to perpetuate the original location of this corner.

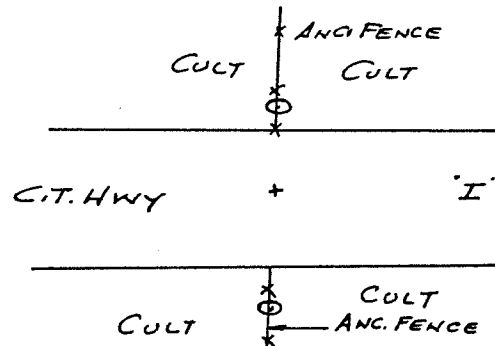

① 1 1/2" IRON PIPE (RED)
MKD W/ T COR T 32 N
R 10 E
SEC. 36 | SEC. 31
SEC. 1 | SEC. 6
T 31 N
50 FT. NORTH TO COR.
SOUTH
NO TREES NEAR.

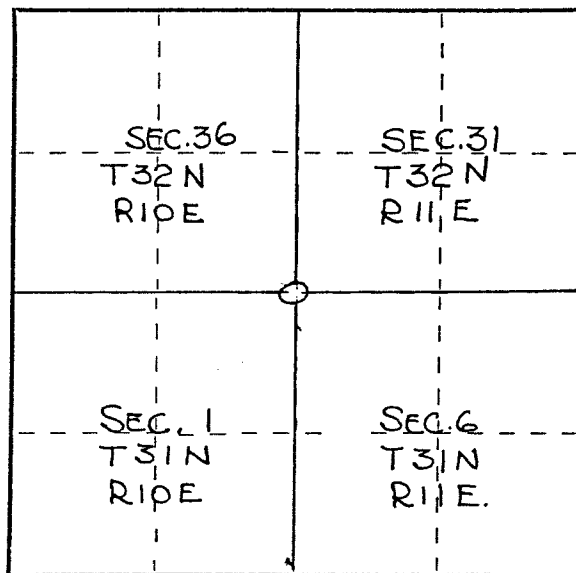

○ = Corner monument restored.

Dated at ELCHO, Wis., this 5TH day of JULY, 1969

Signature Robert J. Poss Title REG. LAND SURVEYOR Registration No. S-0001
(County Surveyor, Registered Land Surveyor, or other duly authorized official)

Office of Register of Deeds, County of _____, I hereby certify that the within instrument was filed in this office for record on the _____ day of _____, 19____ at _____ o'clock _____ M.

(Register of Deeds)

By _____ Deputy