

CERTIFIED LAND CORNER RESTORATION

Index No. T-5

State of Wisconsin }
 County of LANGLADE } ss.

I, WILLIAM F. KELLY, do hereby certify that on the 21ST day of OCTOBER, 1981, I found evidence of the WEST 1/4 corner of SECT. 29 Township 32, North, Range 10 EAST, Fourth Principal Meridian, as described hereon; and that from this evidence I established a new monument and accessories as described hereon to perpetuate the original location of this corner.

Resident witnesses:

.....

FORM 985 H. C. MILLER CO., MILWAUKEE

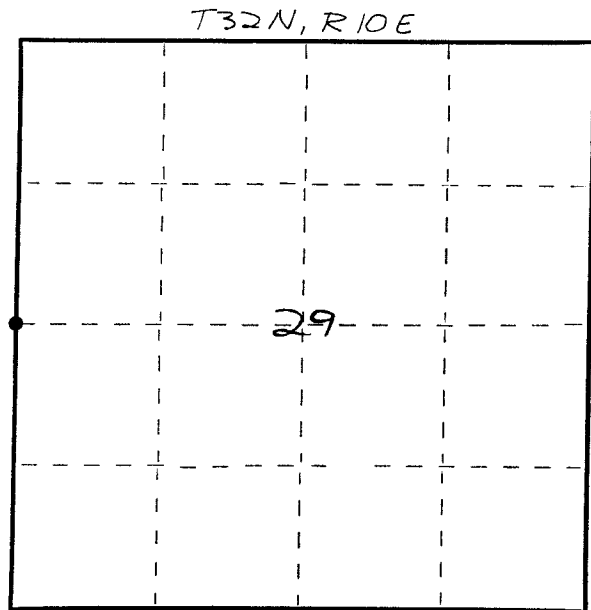

○ = Corner monument restored.

History of original corner establishment:
 ORIGINAL CORNER ESTABLISHED BY
 HIRAM C. FELLOWS IN SEP, 1860

Description of corner evidence found:
 3/4" IRON BAR WITH YELLOW PLASTIC COATING, FOUND IN PLACE.
 I.B. SET BY W.P.S SURVEY OF 1974

*5/26/81 D.T.
 W.P.S. SAYS ANY MARKERS
 IT SET WERE ONLY TRAILERS
 POINTS & NOT NECESSARILY CORNERS*



William F. Kelly

SET A 1 1/2" x 42" BLACK IRON PIPE WITH BRASS CAP W/IT. MONUMENT.
 Description of monument and accessories I established to perpetuate the original location of this corner.

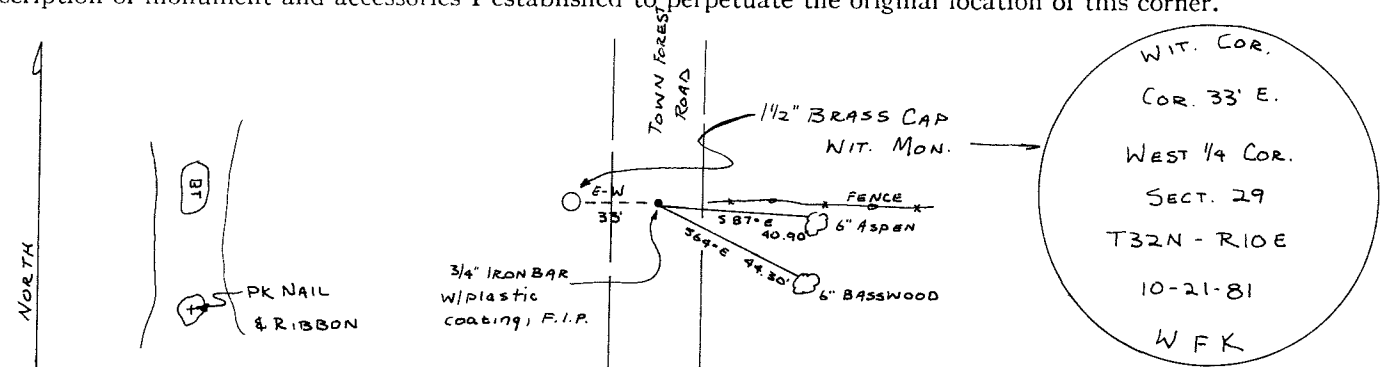

Dated at ELCHO, Wis., this 21ST day of OCTOBER, 1981

Signature William F. Kelly Title COUNTY SURVEYOR Registration No. 1098
 (County Surveyor, Registered Land Surveyor, or other duly authorized official)

Office of Register of Deeds, County of....., I hereby certify that the within instrument was filed in this office for record on the..... day of....., 19..... at..... o'clock..... M.

.....
 (Register of Deeds)

By..... Deputy