

CERTIFIED LAND CORNER RESTORATION

32-10

Index No. 6-22

State of Wisconsin }
County of LANGLADE } ss.

History of original corner establishment:

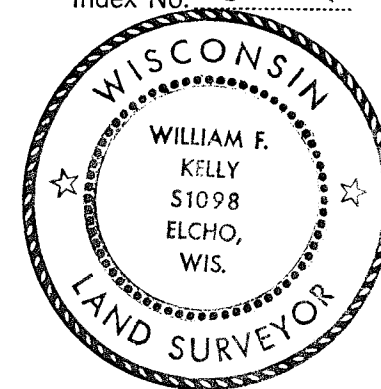

I, W.M. F. KELLY, do hereby certify that on the 20th day of APRIL, 1974, I found evidence of the W 1/4 ON E-W 1/4 LINE corner of SEC. 12 Township 32 North, Range 10 East, Fourth, Principal Meridian, as described hereon; and that from this evidence I established a new monument and accessories as described hereon to perpetuate the original location of this corner.

Description of corner evidence found:

FOUND ANCIENT POST SCRIBE MARKS WEATHERED AWAY AT FENCE COR IN ROCK PILE

William F. Kelly

Resident witnesses:

ROBERT J. POSS

Description of monument and accessories I established to perpetuate the original location of this corner.

SET 1/2" IRON PIPE PAINTED ORANGE W/BRASS CAP

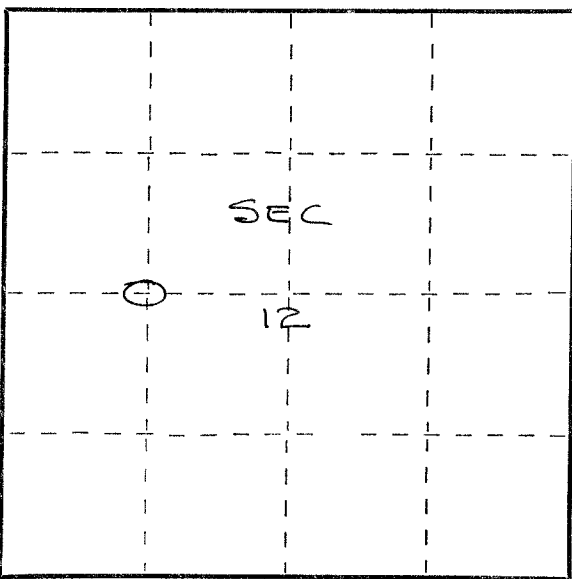
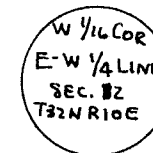
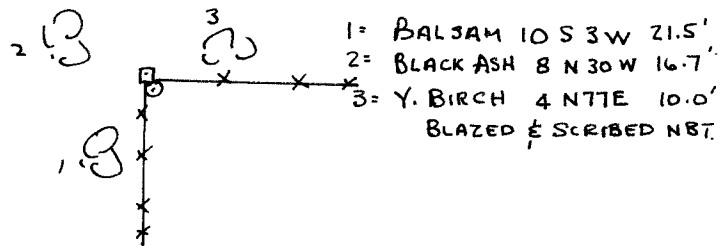

○ = Corner monument restored.

Dated at ELCHO, Wis., this 20th day of APRIL, 1974

Signature William F. Kelly Title REG. LAND SURVEYOR Registration No. 5-1098
(County Surveyor, Registered Land Surveyor, or other duly authorized official)

Office of Register of Deeds, County of _____, I hereby certify that the within instrument was filed in this office for record on the _____ day of _____, 19____ at _____ o'clock _____ M.

(Register of Deeds)

By _____ Deputy