

CERTIFIED LAND CORNER RESTORATION

State of Wisconsin }
County of LANGLADE } ss.

History of original corner establishment:

I, W.M. F. KELLY, do hereby certify that on the 20TH day of APRIL, 1974, I found evidence of the CTR. SECTION corner of SECTION 12 Township 32, North, Range 10 EAST, Fourth, Principal Meridian, as described hereon; and that from this evidence I established a new monument and accessories as described hereon to perpetuate the original location of this corner.

Description of corner evidence found:

FOUND OLD STAKE LYING DOWN BUT HOLE & STONE MOUND IN PLACE



William F. Kelly

Resident witnesses:

ROBERT J. POSS

Description of monument and accessories I established to perpetuate the original location of this corner.

SET 2" IRON PIPE W/BRASS CAP MKD. IN STONE MOUND

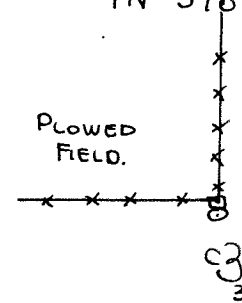
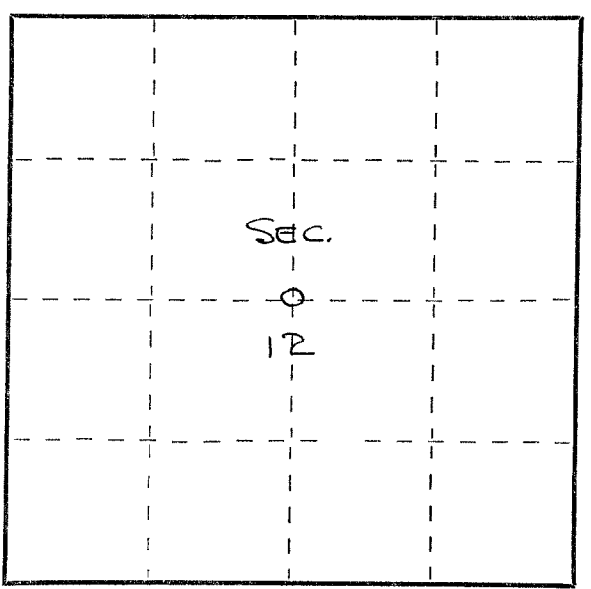

- 1= BLACK ASH 8 S 83-30E 15.5
 - 2= BLACK ASH 8 S 48-00E 10.0
 - 3= BLACK ASH 4 S 1-00E 6.6
- BLAZED & DESCRIBED NBT



Dated at ELCHO, Wis., this 20TH day of APRIL, 1974

Signature William F. Kelly Title REG. LAND SURVEYOR Registration No. S-1098
(County Surveyor, Registered Land Surveyor, or other duly authorized official)

Office of Register of Deeds, County of _____, I hereby certify that the within instrument was filed in this office for record on the _____ day of _____, 19____ at _____ o'clock _____ M.

(Register of Deeds)
By _____ Deputy

○ = Corner monument restored.