

CERTIFIED LAND CORNER RESTORATION

92-10

Index No. J-23

State of Wisconsin }
County of LAFAYETTE } ss.

History of original corner establishment:

ORIGINAL CORNER LOST; REESTABLISHED.

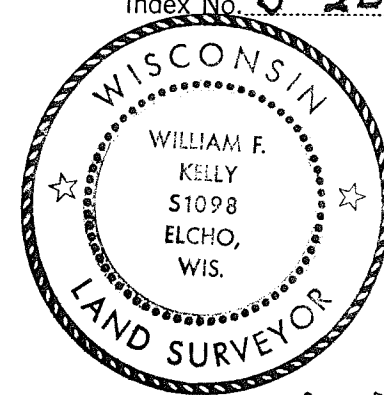

I W^M F. KELLY, do hereby certify that on the 15TH day of MAY, 1974, I found evidence of the 1/4 SECTION corner of SECS. 12 & 13 Township 32 NORTH, North, Range 10 EAST, Fourth Principal Meridian, as described hereon; and that from this evidence I established a new monument and accessories as described hereon to perpetuate the original location of this corner.

Description of corner evidence found:

CORNER INDICATED ON AERIAL PHOTOS; CORNER FALLS IN PLOWED FIELD. ORIGINAL COR. SHOWS AS BEING WEST OF OLD BARN. AREA UNDER CULTIVATION. *William F. Kelly*

Resident witnesses:

.....
.....
.....

Description of monument and accessories I established to perpetuate the original location of this corner.

SET BY PROP. MEASUR. SET 2" - IRON PIPE W/BRASS CAP MKD.
X = 4" x 6" CEDAR & TAMARACK POSTS - FLAGGED.

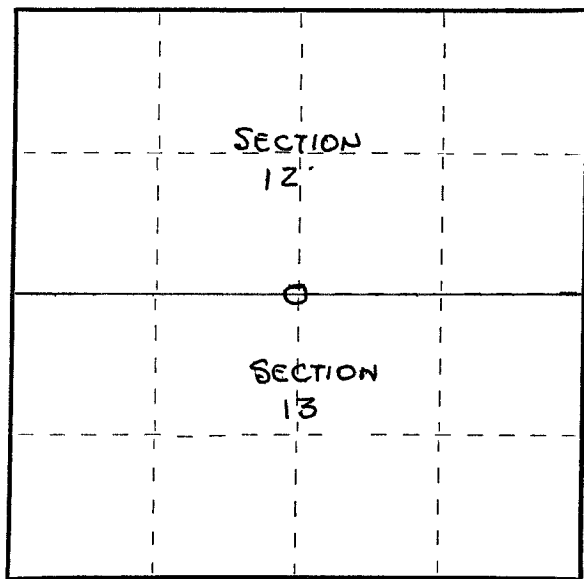
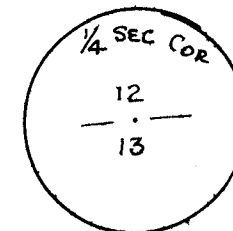
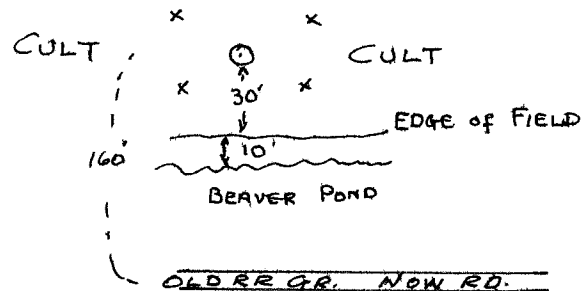

○ = Corner monument restored.

Dated at ELCHO, Wis., this 15TH day of MAY, 1974.

Signature William F. Kelly Title REG. LAND SURVEYOR Registration No. S-1098
(County Surveyor, Registered Land Surveyor, or other duly authorized official)

Office of Register of Deeds, County of _____, I hereby certify that the within instrument was filed in this office for record on the _____ day of _____, 19____ at _____ o'clock _____ M.

(Register of Deeds)

By _____ Deputy