

CERTIFIED LAND CORNER RESTORATION

32-10

Index No. ~~1000~~ J-1

State of Wisconsin }
 County of LANGLADE } ss.

History of original corner establishment:

I ROBERT J. POSS, do hereby certify that on the 20TH day of APRIL, 1974, I found evidence of the SECTION corner of SEC. 12-13-18-7 Township 32, North, Range 10 & 11 EAST, Fourth, Principal Meridian, as described hereon; and that from this evidence I established a new monument and accessories as described hereon to perpetuate the original location of this corner.

PROBABLY SET BY BORTH
 Description of corner evidence found:
2" PIPE - VERY OLD.

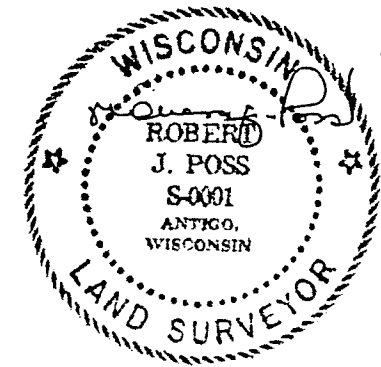

Resident witnesses:

W.F. KELLY

G. RITZ

Description of monument and accessories I established to perpetuate the original location of this corner.

SET 2" PIPE W/BRASS CAP MKD.



NO GOOD REFERENCES NEARBY

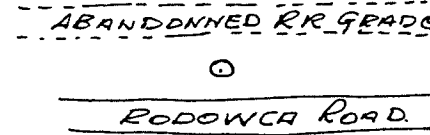
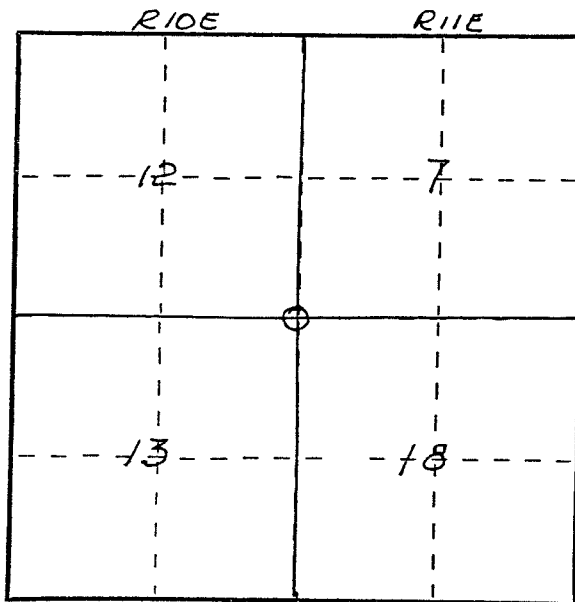

Dated at ANTIGO, Wis., this 20TH day of APRIL, 1974.

Signature Robert J. Poss Title REG. LAND SURVEYOR Registration No. S-0001
 (County Surveyor, Registered Land Surveyor, or other duly authorized official)

Office of Register of Deeds, County of _____, I hereby certify that the within instrument was filed in this office for record on the _____ day of _____, 19____ at _____ o'clock _____ M.

(Register of Deeds)

By _____ Deputy

○ = Corner monument restored.