

CERTIFIED LAND CORNER RESTORATION

32-10

Index No. J-19

State of Wisconsin }
County of LANGLADE } ss.

History of original corner establishment:

I, WM F KELLY, do hereby certify that on the 16TH day of MAY, 1974, I found evidence of the 1/4 SECTION corner of SECS. 11 & 14 Township 32, North, Range 10 EAST, Fourth Principal Meridian, as described hereon; and that from this evidence I established a new monument and accessories as described hereon to perpetuate the original location of this corner.

SEE CORRECTED COR BY DT. 11/02/01

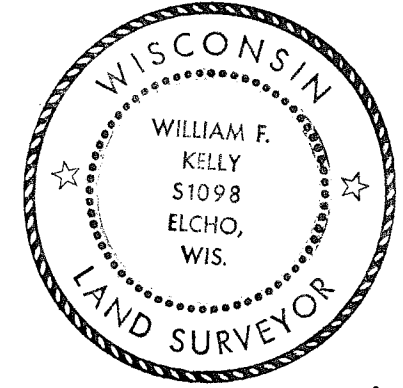

William F. Kelly

Description of corner evidence found:

NO EVIDENCE FOUND. PRORATED DISTANCE BETWEEN SEC. COR 10-11-14-15E 12-7-18-13 CORNER FALLS AT EDGE OF NEW CULTIVATION TO SOUTH & EAST; PHOTOS SHOW WOODS LINE & FIELDS MEANDERING TO NORTH.

Resident witnesses:

Description of monument and accessories I established to perpetuate the original location of this corner.

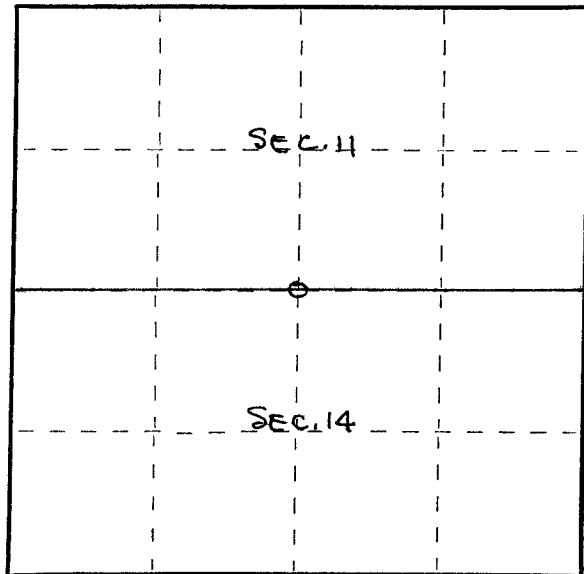
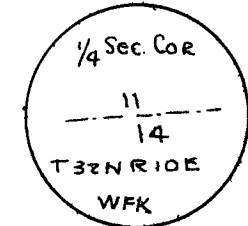
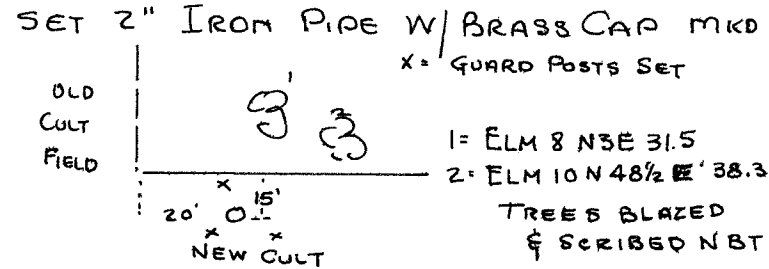

○ = Corner monument restored.

Dated at ELCHO, Wis., this 16TH day of MAY, 1974.

Signature William F. Kelly Title REG. LAND SURVEYOR Registration No. S-1098
(County Surveyor, Registered Land Surveyor, or other duly authorized official)

Office of Register of Deeds, County of _____, I hereby certify that the within instrument was filed in this office for record on the _____ day of _____, 19____ at _____ o'clock _____ M.

(Register of Deeds)

By _____ Deputy

FORM 985 H. C. MILLER CO., MILWAUKEE