

CERTIFIED LAND CORNER RESTORATION

32-10
Index No. J-21

State of Wisconsin }
County of LANGLADE } ss.

History of original corner establishment:
ORIGINAL CORNER LOST

I, W^M F. KELLY, do hereby
certify that on the 15TH day
of MAY, 1974, I found
evidence of the SECTION
corner of SECS. 11, 12, 13, 14
Township 32, North, Range
10 EAST, Fourth Principal Meridian,
as described hereon; and that from this evidence
I established a new monument and accessories
as described hereon to perpetuate the original
location of this corner.

*SEE CORRECTED
COR BY D.T. 11/02/01*

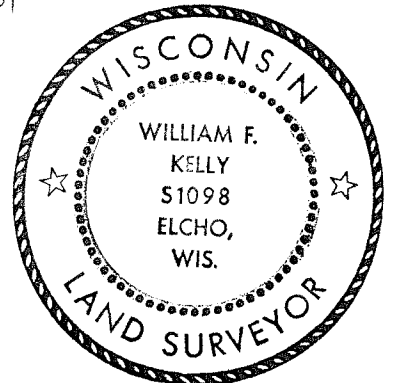

William F. Kelly

Description of corner evidence found:
PROPORTIONED DIST. BETWEEN SECS.
ACCORDING TO ORIG. FIELD NOTES.
RESET COR.

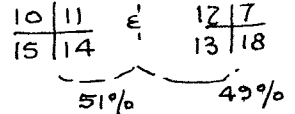

Resident witnesses:

C. A. McEACHERN

Description of monument and accessories I established to perpetuate the original location of this corner.

SET 2" IRON PIPE W/BRASS CAP MKD
SET GUARD POSTS IN SQUARE W/FIELD STONES AROUND PIPE.

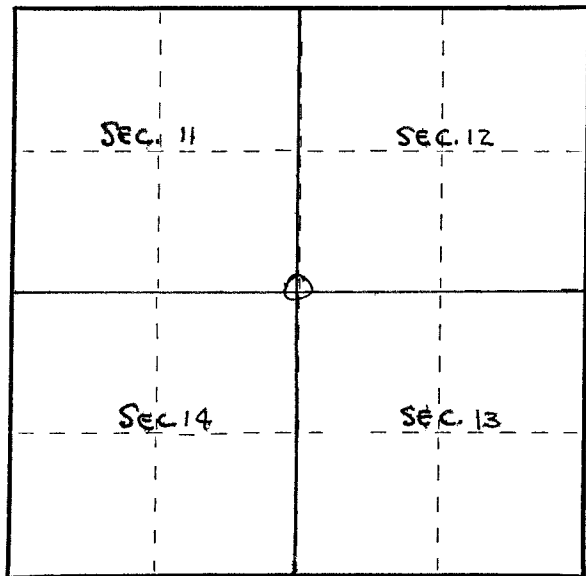
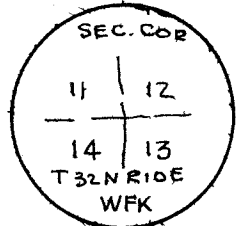
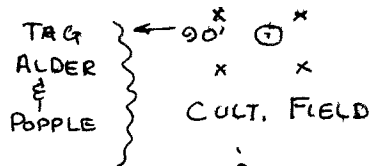

○ = Corner monument restored.

Dated at ELCHO, Wis., this 15TH day of MAY, 1974.

Signature William F. Kelly Title REG. LAND SURVEYOR Registration No. S-1098
(County Surveyor, Registered Land Surveyor, or other duly authorized official)

Office of Register of Deeds, County of _____, I hereby certify that the within
instrument was filed in this office for record on the _____ day of _____, 19____
at _____ o'clock _____ M.

(Register of Deeds)

By _____ Deputy