

CERTIFIED LAND CORNER RESTORATION

32-10

Index No. J-15

State of Wisconsin }  
 County of LANGLADE } ss.

History of original corner establishment:

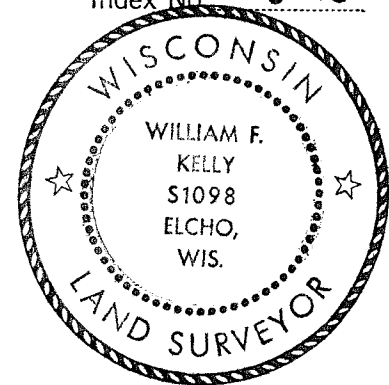

I, Wm. F. Kelly, do hereby certify that on the 13<sup>TH</sup> day of MAY, 1974, I found evidence of the 1/4 SECTION corner of SECS. 10 & 15 Township 32, North, Range 10 EAST, Fourth Principal Meridian, as described hereon; and that from this evidence I established a new monument and accessories as described hereon to perpetuate the original location of this corner.

Description of corner evidence found:

FOUND 1" STEEL PIN & 1/2" L IRON. OLD 4"x4" WOOD STAKE ROTTED OFF LYING NEXT TO STEEL PIN. ROTTED REMAINS OF STAKE IN HOLE ABOUT AN. REMAINS OF HEM. STUMP W/BLAZE.

*William F. Kelly*

Resident witnesses:

R. KOHN  
 \_\_\_\_\_  
 \_\_\_\_\_

Description of monument and accessories I established to perpetuate the original location of this corner.

SET 2" IRON PIPE W/ BRASS CAP MKD.

FORM 985 H. C. MILLER CO., MILWAUKEE

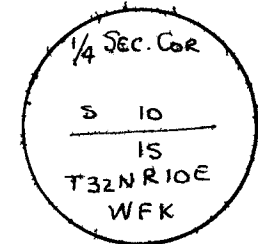
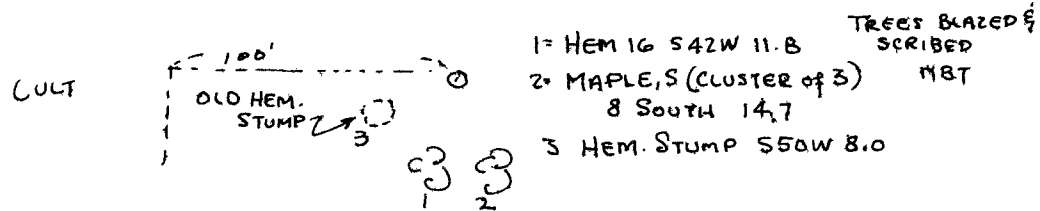
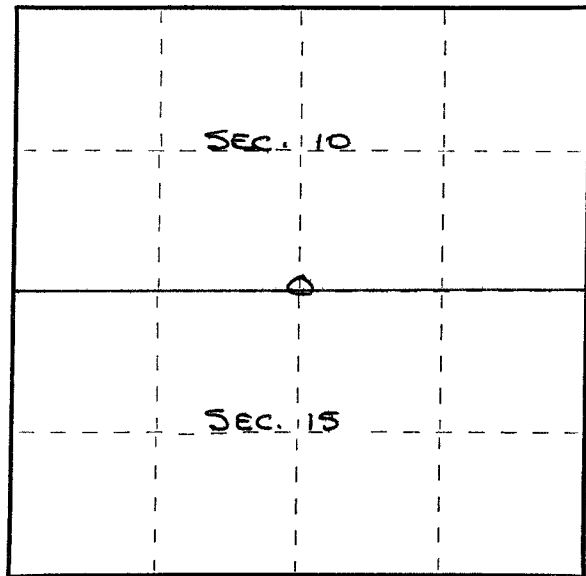

Dated at ELCHO, Wis., this 13<sup>TH</sup> day of MAY, 1974.

Signature William F. Kelly Title REG. LAND SURVEYOR Registration No. S-1098  
 (County Surveyor, Registered Land Surveyor, or other duly authorized official)

Office of Register of Deeds, County of \_\_\_\_\_, I hereby certify that the within instrument was filed in this office for record on the \_\_\_\_\_ day of \_\_\_\_\_, 19\_\_\_\_ at \_\_\_\_\_ o'clock \_\_\_\_\_ M.

(Register of Deeds)

By \_\_\_\_\_ Deputy

○ = Corner monument restored.