

CERTIFIED LAND CORNER RESTORATION

32-10

Index No. J-12

State of Wisconsin }
County of LANGLADE, } ss.

History of original corner establishment:

I, Wm. F. KELLY, do hereby certify that on the 9TH day of MAY, 1974, I found evidence of the SECTION corner of SECS. 10-11-14-15 Township 32, North, Range 10E, Fourth Principal Meridian, as described hereon; and that from this evidence I established a new monument and accessories as described hereon to perpetuate the original location of this corner.

Description of corner evidence found:

5 ANGLE IRONS WELDED TOGETHER WITH POINT ON END.
ROTTEN WOOD IN HOLE WHERE L IRONS WERE SET.
ALSO AT JCN BLAZED CUTTING LINES.



William F. Kelly

Resident witnesses:

C.A. McEACHEREN
R. KOHN

Description of monument and accessories I established to perpetuate the original location of this corner.

SET 2" IRON PIPE W/ BRASS CAP MKD.
NEXT TO L IRON.



- 1= MAPLE S=5 N46°W 19.6
- 2= SPRUCE W-8 S25°W 35.1
- 3= BALSAM 8 S37E 30.0

ALL TREES BLAZED AND SCRIBED NBT

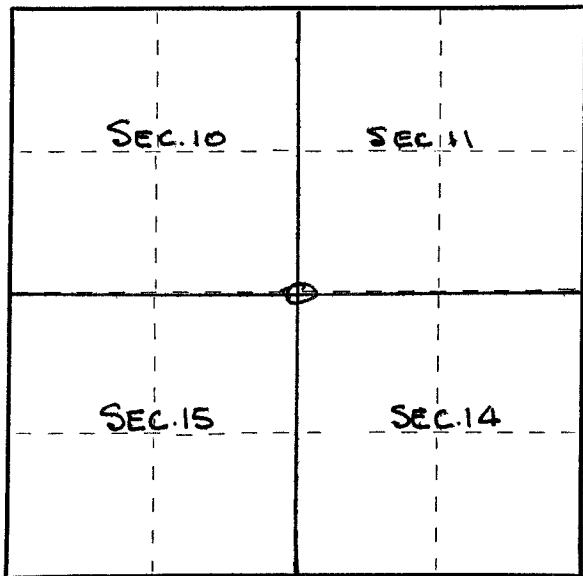
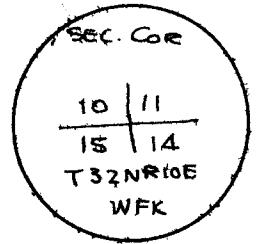

○ = Corner monument restored.

Dated at ELCHO, Wis., this 9TH day of MAY, 1974.

Signature William F. Kelly Title REG. LAND SURVEYOR Registration No. S-1098
(County Surveyor, Registered Land Surveyor, or other duly authorized official)

Office of Register of Deeds, County of _____, I hereby certify that the within instrument was filed in this office for record on the _____ day of _____, 19____ at _____ o'clock _____ M.

(Register of Deeds)

By _____ Deputy